

Ex Parte
Albert S. Smith.

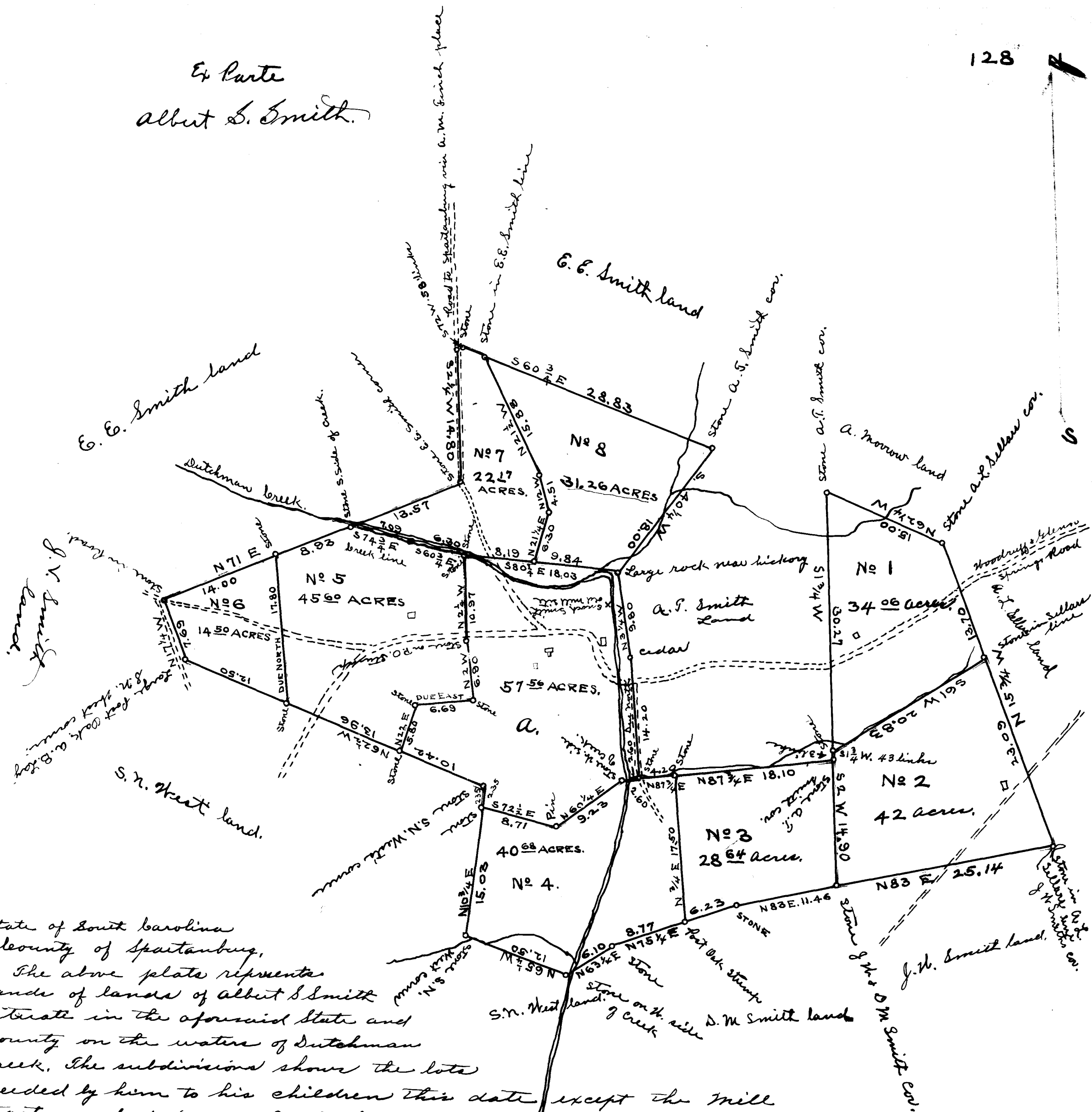

State of South Carolina
 County of Spartanburg,
 The above plat represents
 lands of Albert S. Smith
 situated in the aforesaid State and
 County on the waters of Dutchman
 Creek. The subdivisions show the lots
 decided by him to his children this date except the mill
 tract marked (a), which he retains as his own.
 The red lines show the parts surveyed by me and the
 single black lines show parts of the plat taken from
 a survey made by R. W. Williams in 1896 allowing
 3/4 degree for the magnetic variation. I believe these
 black lines were correctly surveyed but do not
 vouch for them. This March 9th 1909.
 W. H. Harris
 Surveyor.

Registered, Certified & Examined October 28th 1909.