

EX PARTE
G., S. & A. RY. CO

EXHIBIT "A"

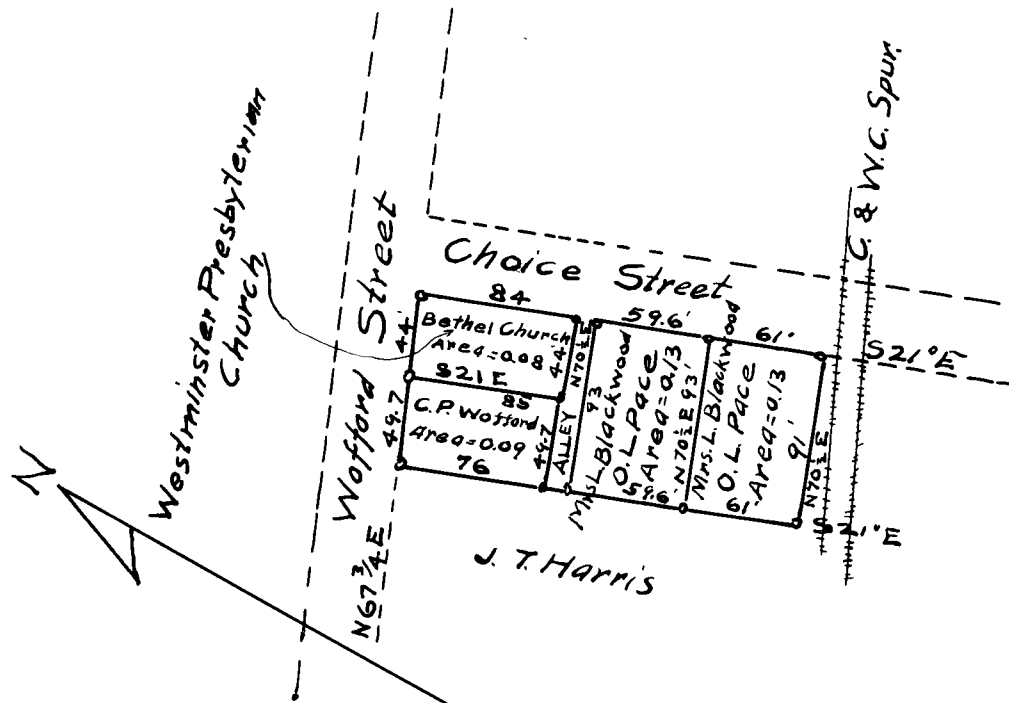

Conveyed by
Westminster Presbyterian Church
C. P. Wofford
Mrs. L. Blackwood
O. L. Pace

G. S. & A. Ry. Co.
Spartanburg Terminal Property
Scale 1"=100' - May. 7, 1912

NOTE:
SEE DEED BOOK "5-D" PAGE " 688."

Registered, certified & Examined Sept. 21-1912