

4 parts
Southern Railway Co.

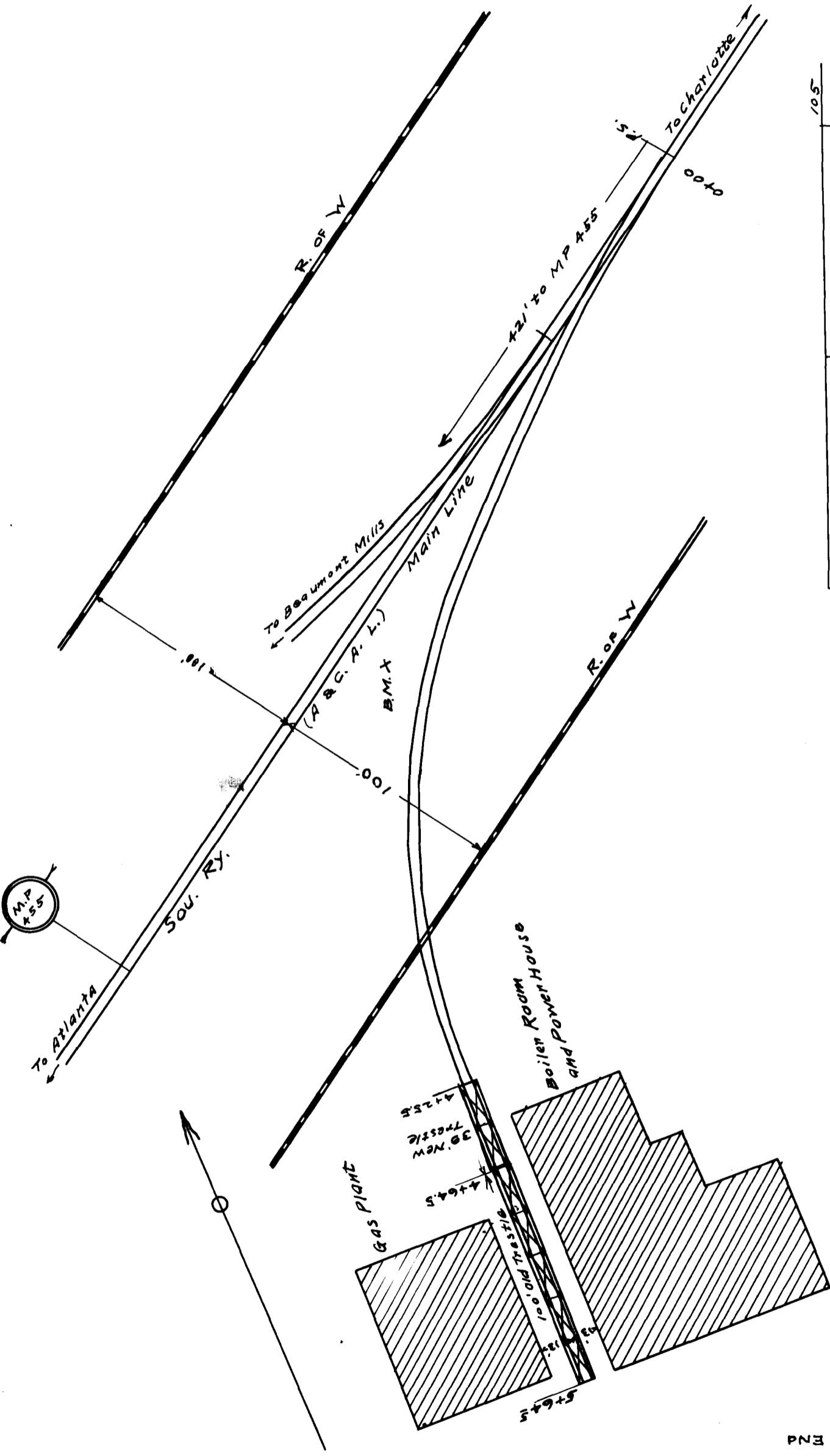

105	Base of Rail	Main Line	1
100	Base of Rail	Main Line	2
95	Base of Rail	Main Line	3
90	Base of Rail	Main Line	4
85	Base of Rail	Main Line	5
80	Base of Rail	Main Line	6
75	Base of Rail	Main Line	7
70	Base of Rail	Main Line	8

DATUM ASSUMED.
Nearest Govt. B. M. 20 Mi. Gafney No. 779 E. 779.084
Nearest Sou. Ry. B. M. 19 Mi. No. 436.4
B.M. for this Survey. Angle Bar Driven in Ground
20' E. of Main Track 170' N. of M.P. 455.
Elev. Assumed as 100.00
Office of Eng. M. of W. Eastern District
Charlotte, N. C., July 12, 1913
Survey & Drawing by E.M.W.

SOUTHERN RAILWAY
CHARLOTTE DIVISION
SPARTANBURG, S. C.
Sketch Showing Extension of Coal Trestle
for S. C. Light Power & Railway Co.
Scale 1" = 50'
July 12 '13
E. M. W.

Approved: *J. Johnson*

Note: See Book 5-K page 50

Registered, Certified & Examined Dec. 29 - 1913