

EX PARTE
CONVERSE HEIGHTS BLOCK #13

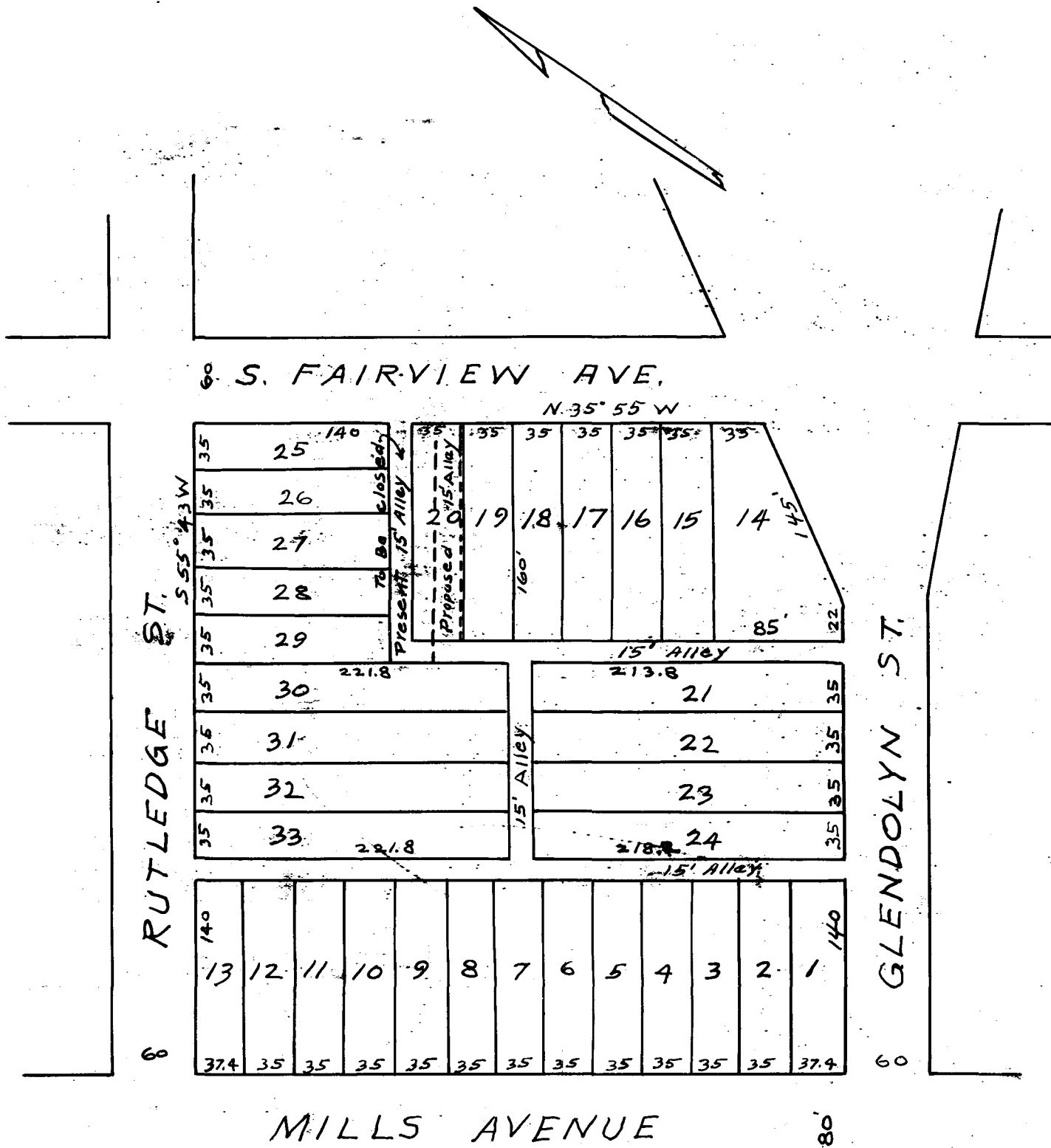

CONVERSE HEIGHTS
BLOCK 13

SPARTANBURG - S.C.

PROPOSED CHANGE OF ALLEY

ON LOT No 20

Scale 1" = 100' May 6-1929

W.N. WILLIS, CON. ENGR.

SPAR., S.C.

Registered, Certified & Examined April 13-1929 at 1:27 P.M.