

EX PARTE
A.V. WHITE

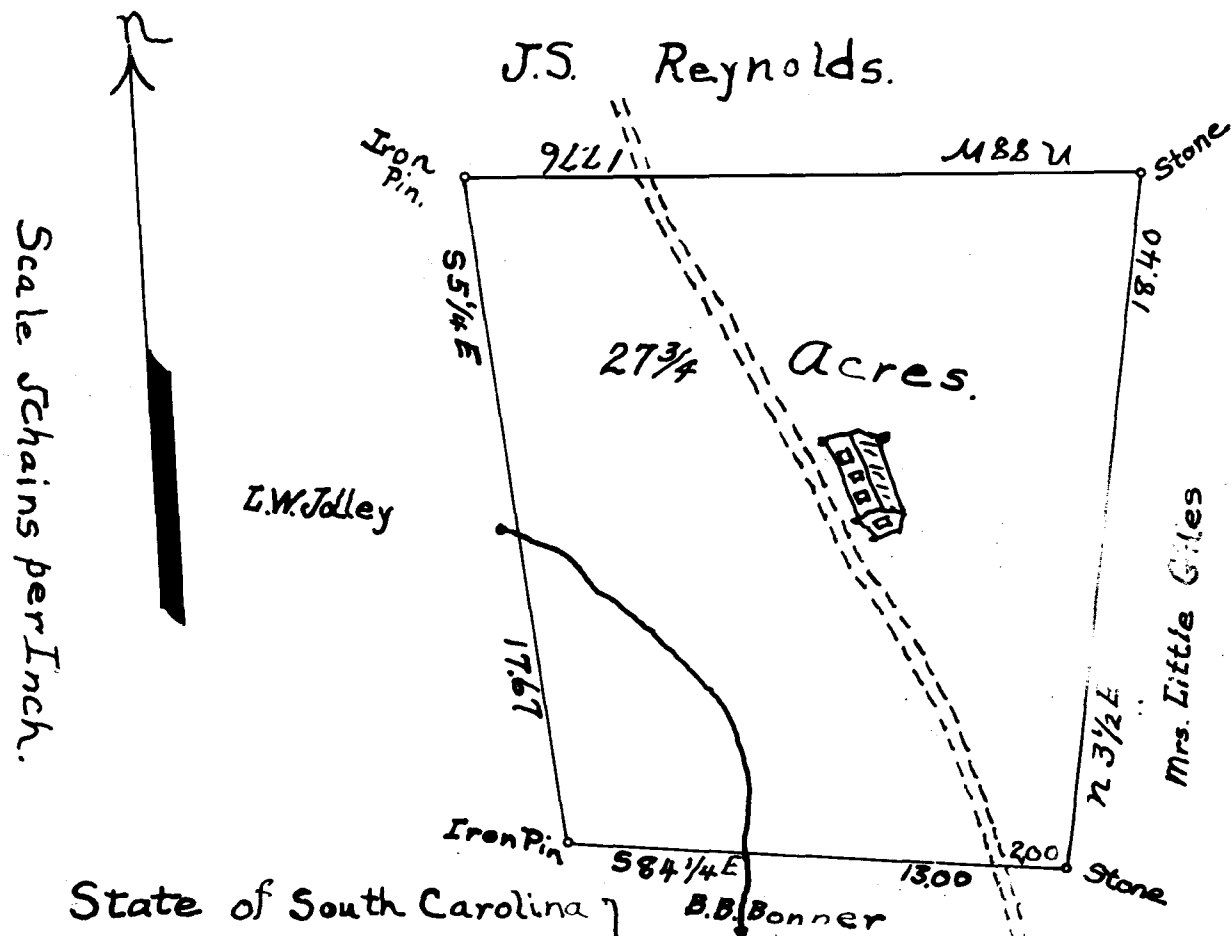

State of South Carolina }
 County of Spartanburg } The above map
 represents A.V. White's plot of land bought
 from Abner Cantrell January 9th, 1925.
 Re-surveyed by, Jan. 8th 1925 at request of Mr. White
 Jno. B. Cash L.S.

Registered, certified and examined November 20th 1930 at 2:15 P.M.