

EX PARTE
Z.V. & B.B. JOLLEY

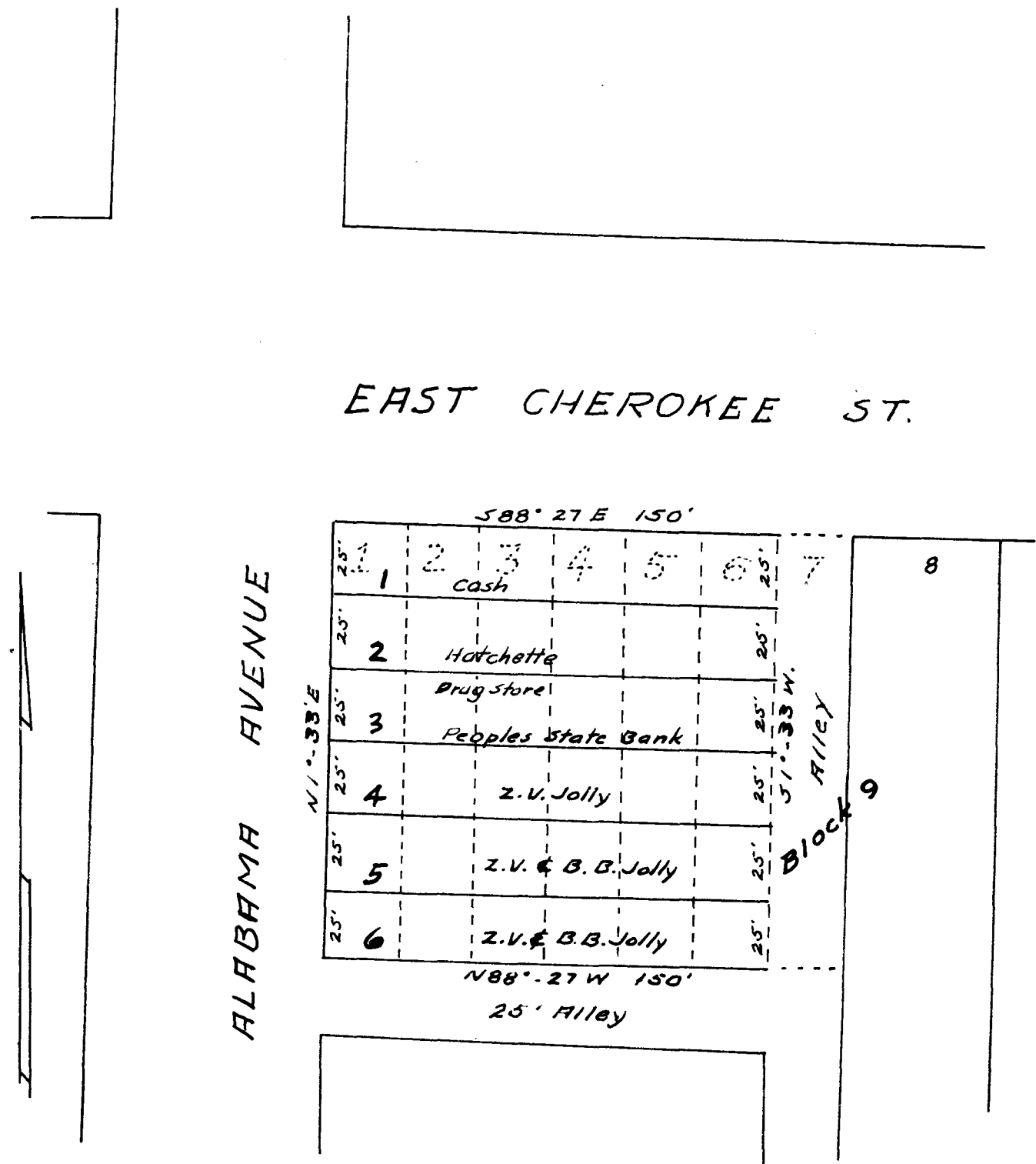

CHESNEE

SPARTANBURG CO. S.C.
Revision of Block 9
under date of Nov 1909
for Chesnee Land Co
Scale 1 1/2" = 50' May 2 1934
W.N. Willis C.E.

Registered, Identified & Examined May 2 - 1934 at 11:53 a.m.