

EX PARTE
R. A. CARRUTH

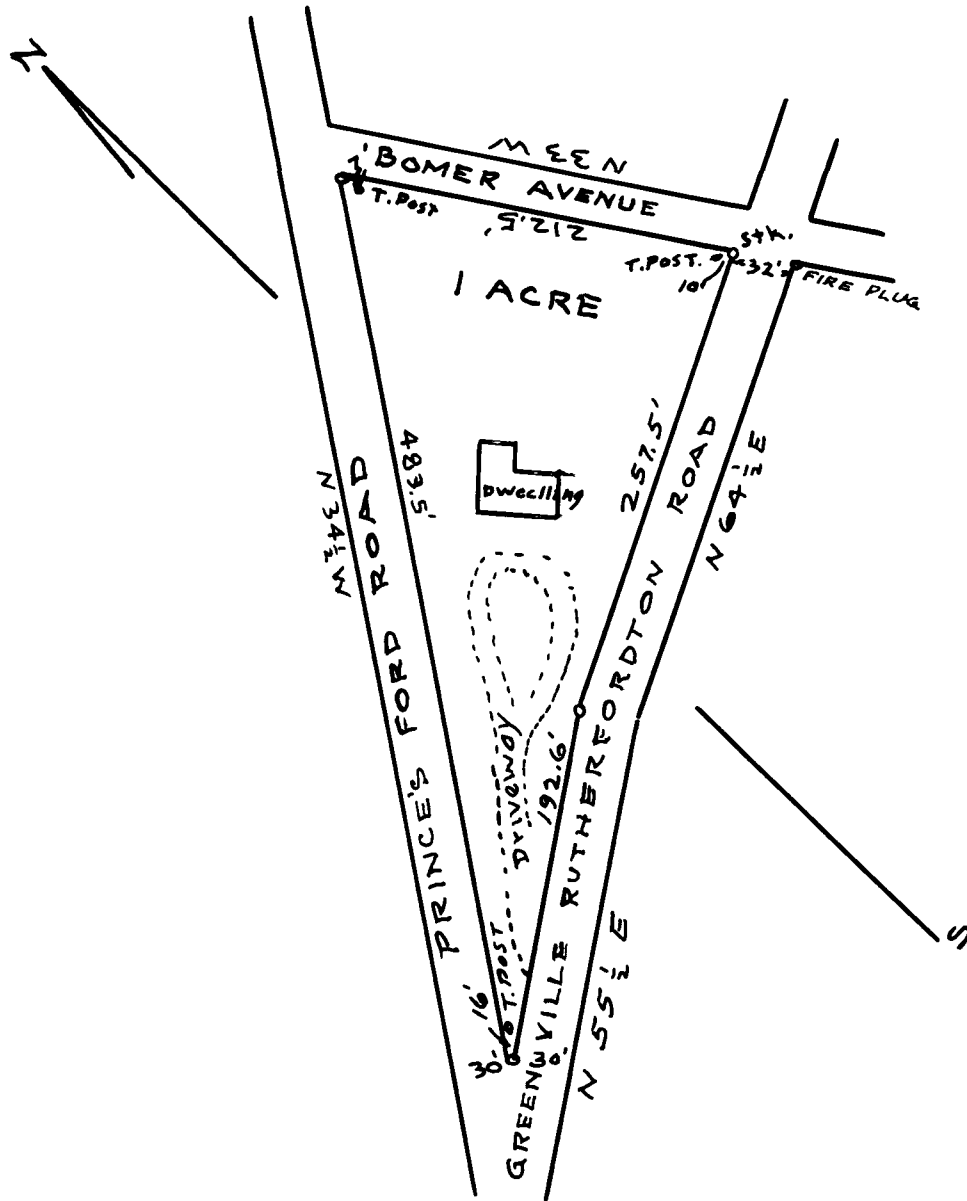

PROPERTY OF
 R. A. CARRUTH
 LANDRUM, S.C., IN CAMPOBELLO TOWNSHIP
 SPARTANBURG COUNTY, S.C.

SCALE: 1" = 100'

AUGUST 21, 1934

W. H. LADSHAW, SURVEYOR
 LANDRUM, S.C.

Registered, Certified & Examined August 24, 1934 at 10:08 a.m.