

EX PARTE
J. B. & J. F. CLEVELAND ESTATES

CITY OF

N 18° 05' W →
433.8

150

DIVISION

434.7'

62.5'

64.5'

117'

56.1'

432.5'

49.9'

S. BECKER ESTATE

S 70° 59' W →

187.6'

183.7'

DIVISION B

DIVISION B

A

DIVISION

1-5-BRICK

1-5-

182'

180.1'

A

B

C

115'

58'

49.8'

← S 19° 30' E

12'

S. CHURCH ST.

SPARTANBURG

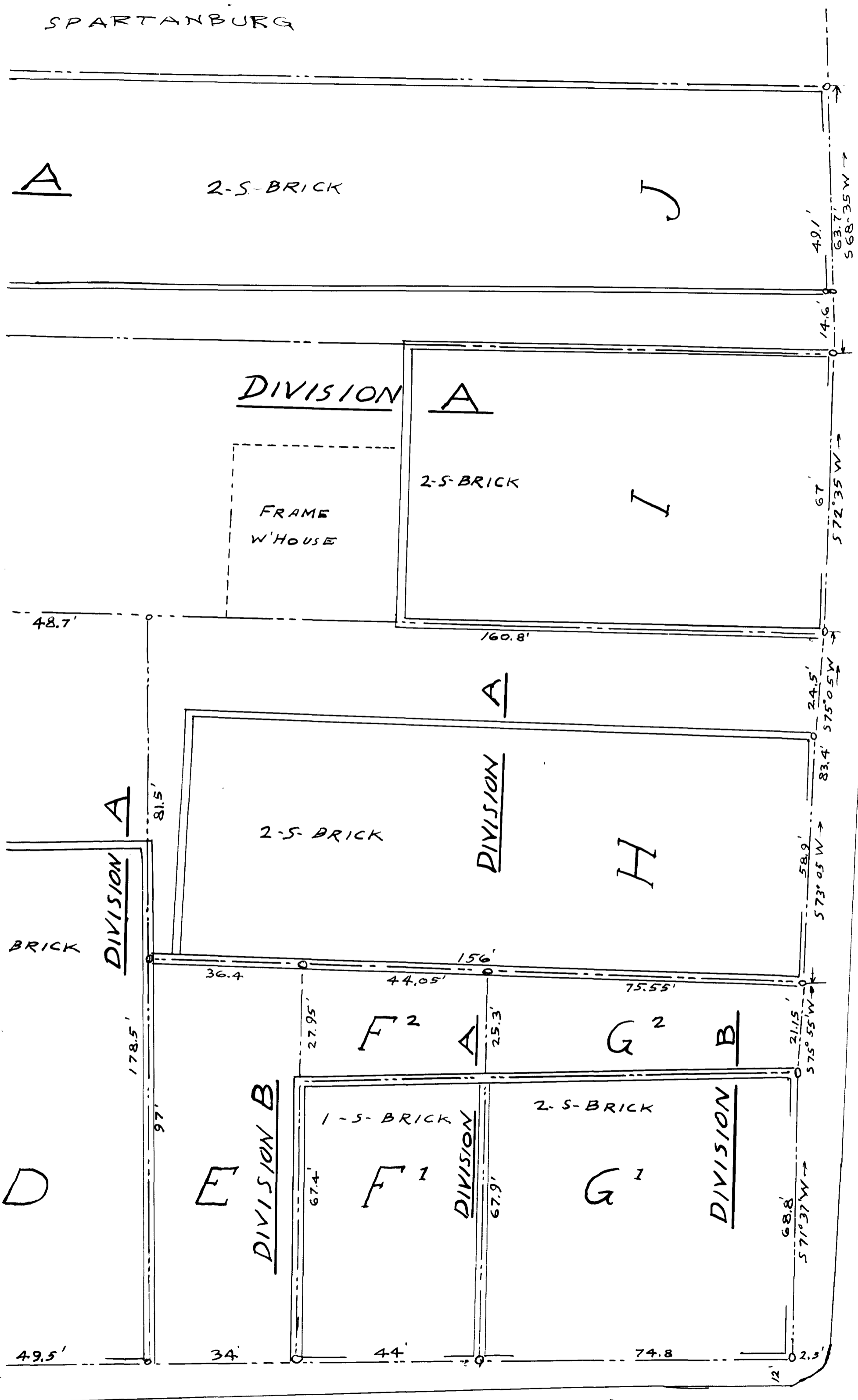

JOINT PROPERTY
OF
J. B. CLEVELAND EST. ST.
AND
J. F. CLEVELAND EST.

PLAT No. 2

SPARTANBURG, S.C. H. STRIBLING, C.E. Dec. 2, 1937

SCALE 1" = 20'

BROAD

Registered, certified + Examined Jan'y 6-1938 at 9:44 a.m

N