

24.

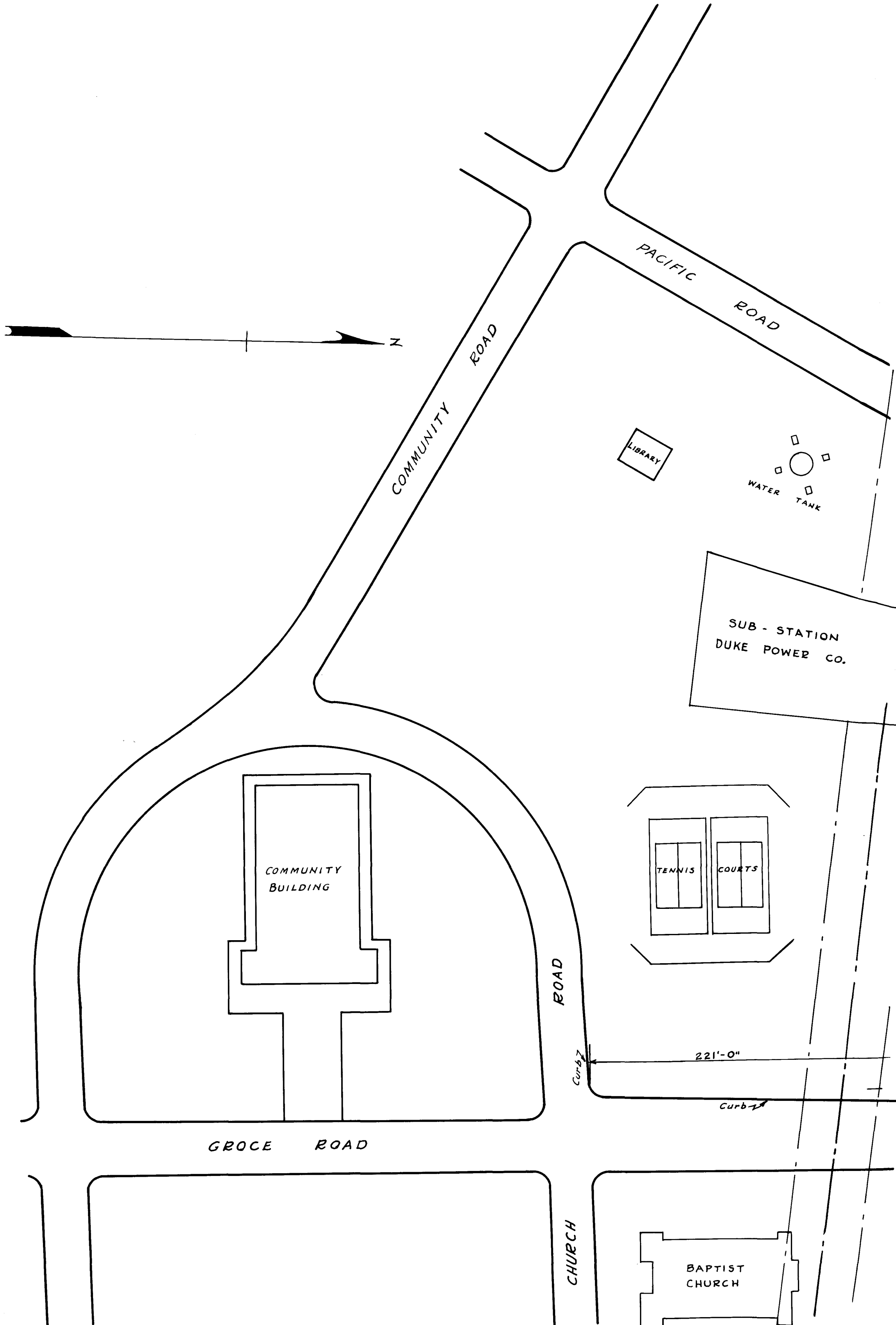

COMMUNITY ROAD

PACIFIC ROAD

LIBRARY

WATER TANK

SUB - STATION
DUKE POWER CO.

COMMUNITY
BUILDING

TENNIS

COURTS

ROAD

Curb

221'-0"

Curb

GROCE ROAD

CHURCH

BAPTIST
CHURCH

EXPARTE
PACIFIC MILLS

ARMORY LOCATION

PACIFIC MILLS

Lyman Division

Lyman, S.C.

Scale 1" = 50'

Jan, 14, 1936

36-1-2

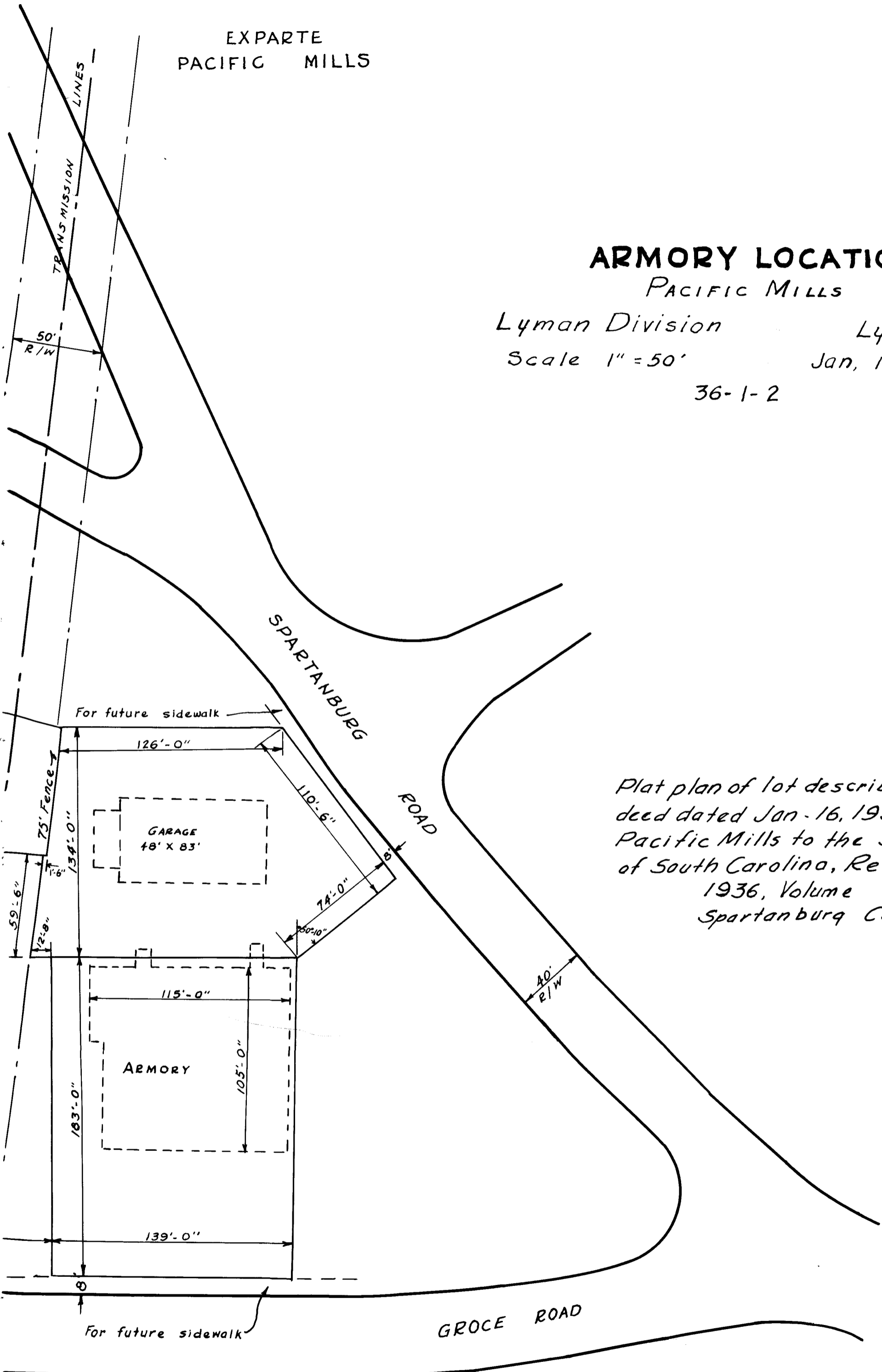

Plat plan of lot described in deed dated Jan-16, 1936 by Pacific Mills to the State of South Carolina, Recorded 1936, Volume Page Spartanburg County

Registered, Certified & Examined June 10th 1938 at 2:05 P.M.