

EX PARTE
R. L. BOWDEN EST.

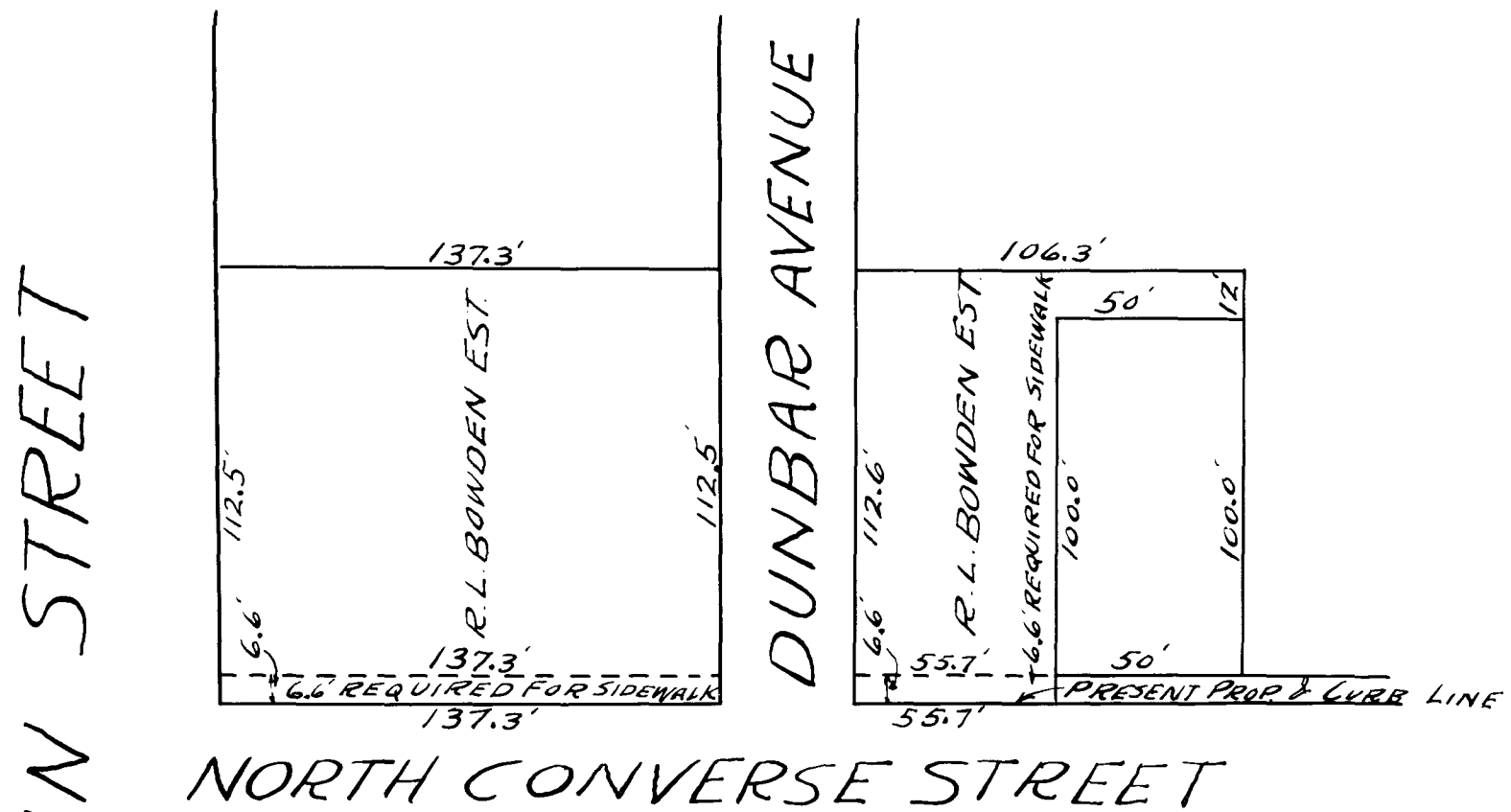

NORTH CONVERSE STREET

PLAT

PROPERTY THAT CITY OF SPARTANBURG, S.C.
IS ACQUIRING FROM R. L. BOWDEN EST. FOR SIDEWALK

HOMER L. HALL

JAN. 30TH, 1940

STREET DEPT.

SCALE 1" = 50'

Registered, certified & Examined March 13TH 1940 at 3:20 P.M.