

578

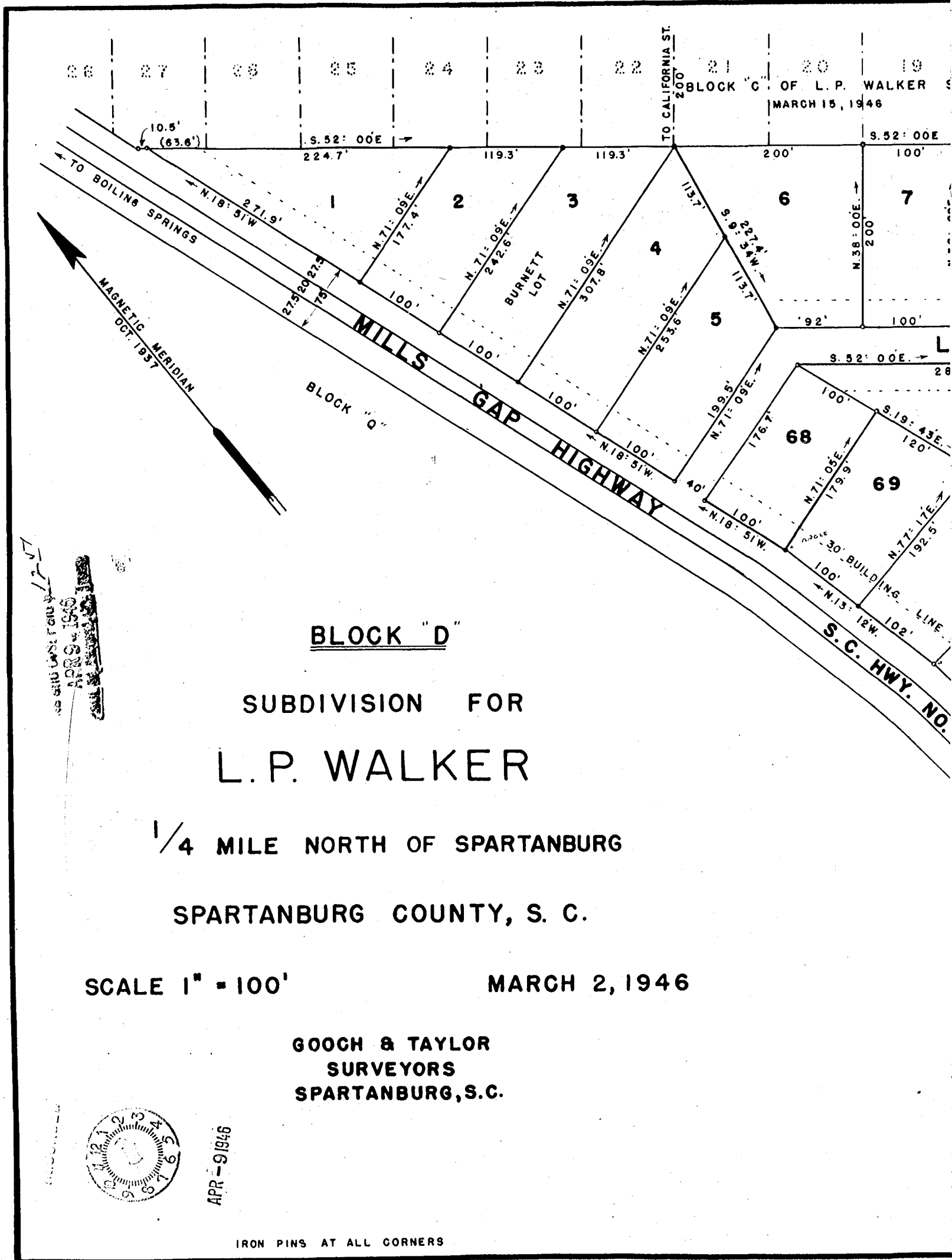

see also last plat 17-57
 APR 9 1946
 17-57

BLOCK "D"

**SUBDIVISION FOR
L.P. WALKER**

1/4 MILE NORTH OF SPARTANBURG

SPARTANBURG COUNTY, S. C.

SCALE 1" = 100'

MARCH 2, 1946

**GOOCH & TAYLOR
SURVEYORS
SPARTANBURG, S.C.**



APR - 9 1946

IRON PINS AT ALL CORNERS