

314

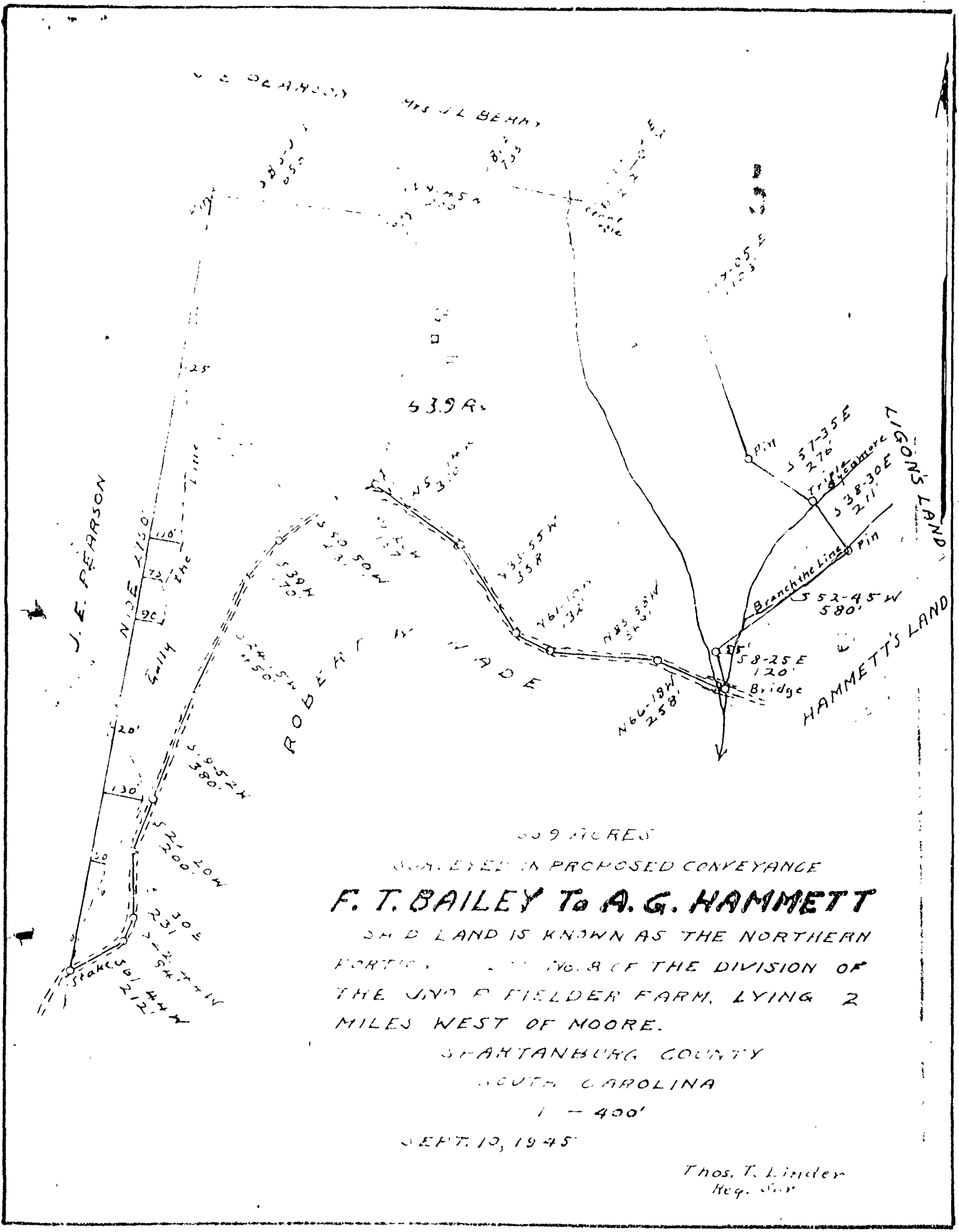

539 ACRES
 SURVEYED IN PROPOSED CONVEYANCE
F. T. BAILEY To A. G. HAMMETT
 SAID LAND IS KNOWN AS THE NORTHERN
 PORTION OF TRACT NO. 8 OF THE DIVISION OF
 THE JUD F. FIELDER FARM, LYING 2
 MILES WEST OF MOORE.
 SPARTANBURG COUNTY
 SOUTH CAROLINA
 1 - 400'
 SEPT. 10, 1945

Thos. T. Linder
 Reg. Sur.