

218

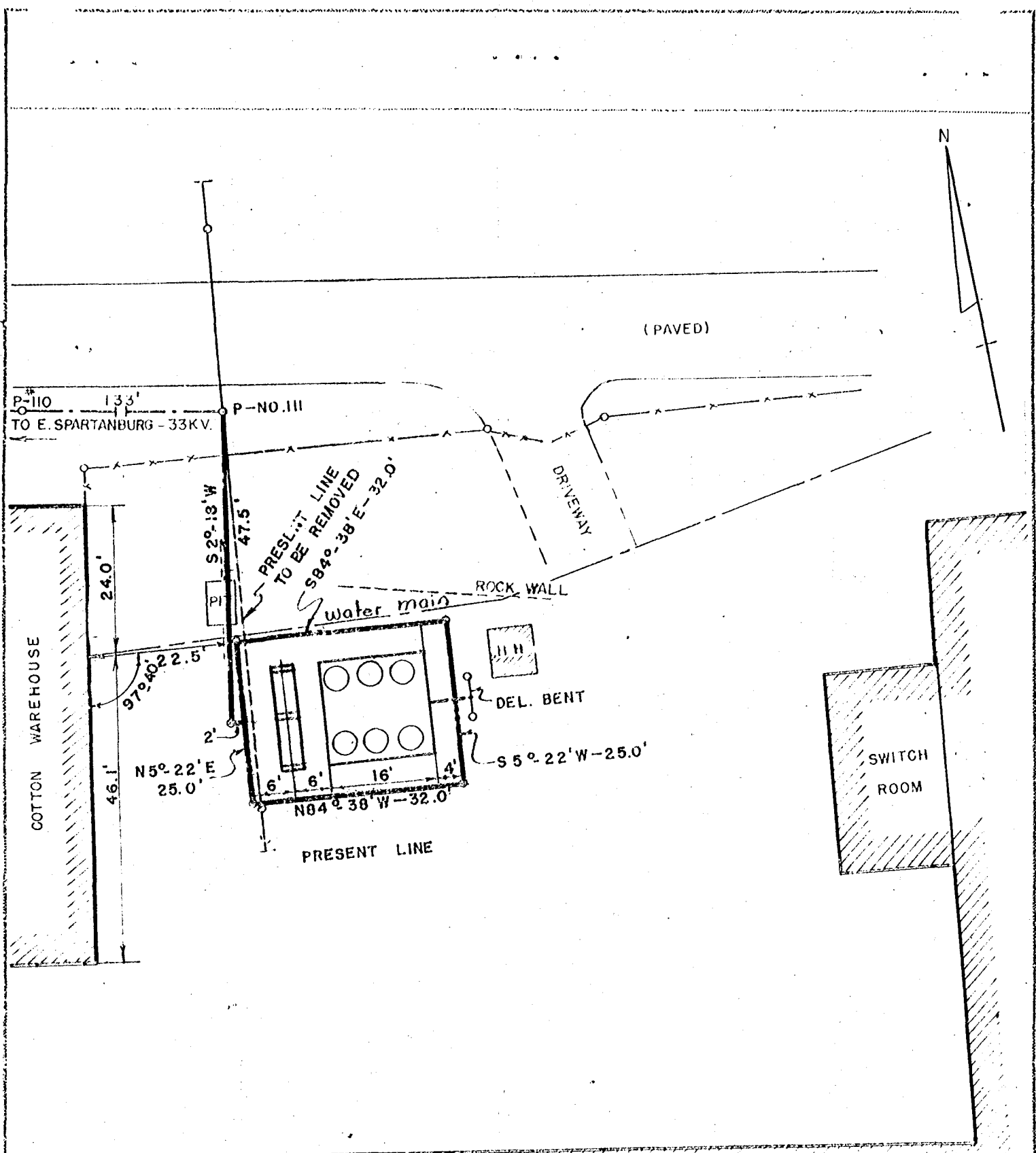

GLENDALE MILLS, INCORPORATED

Fees and Cost Paid \$14.50

SEP 30 1948

PAUL M. MURPH, CO. Treas.

SEP 30 1948



RECORDED

NOTE: SUBSTATION LOT REVISED AUG. 19, 1948 REVISED 9-7-48

DUKE POWER COMPANY
 RELOCATION OF
 SUBSTATION LOT
 AT
 GLENDALE MILLS, INCORPORATED
 GLENDALE, S. C.

SCALE: 1" = 20'
BOOK NO. 246 & 266

AUG. 3, 1948
FILE NO. 4-124