

121

EX PARTE  
J. J. GENTRY

Scale of ten chains per inch

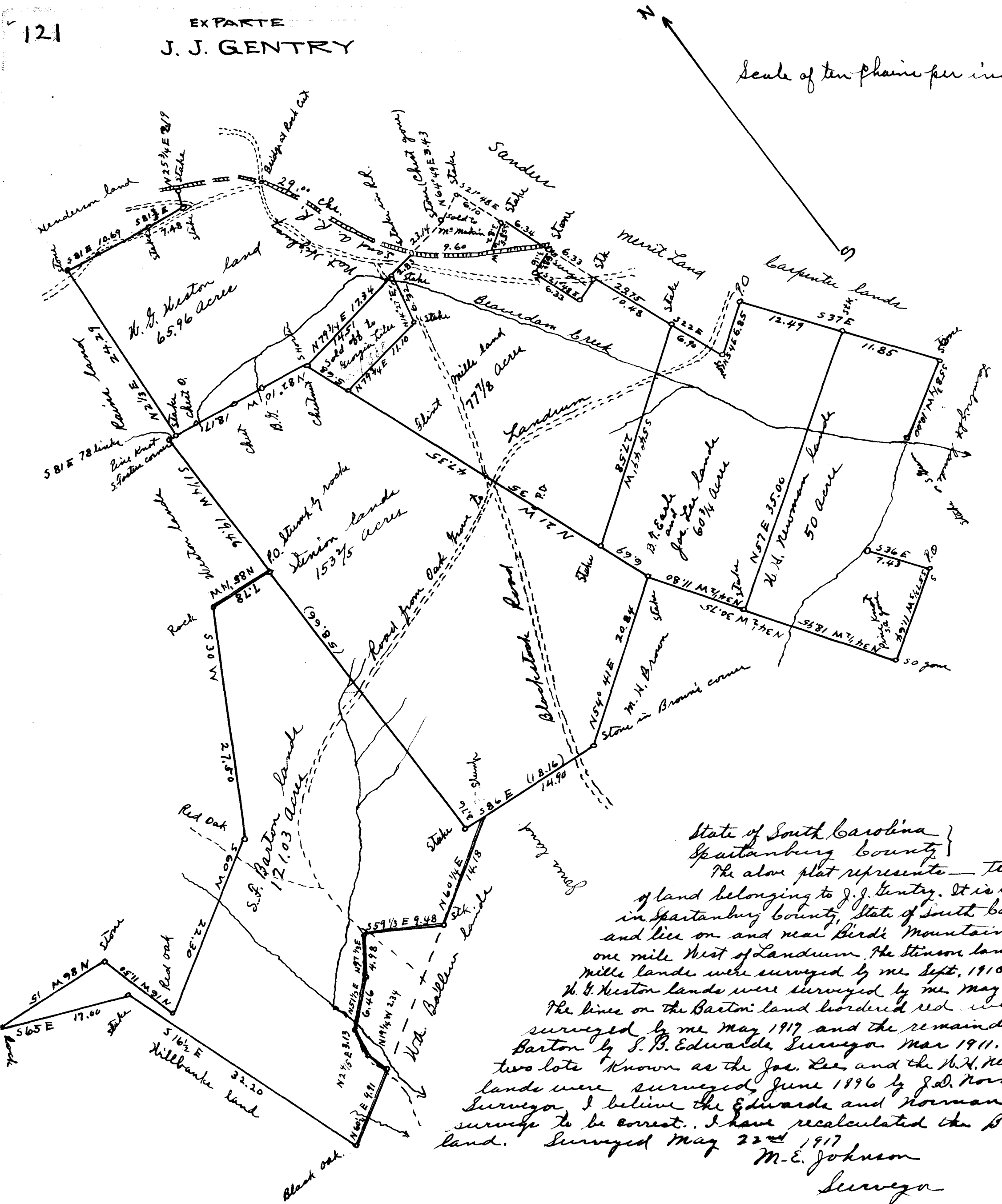

State of South Carolina }  
 Spartanburg County }  
 The above plat represents tracts  
 of land belonging to J. J. Gentry. It is situated  
 in Spartanburg County, State of South Carolina,  
 and lies on and near Bird's Mountain about  
 one mile West of Landrum. The Stinson land and  
 Mill's land were surveyed by me Sept. 1910. The  
 W. G. Heston lands were surveyed by me May 1917.  
 The lines on the Barton land bordered red were  
 surveyed by me May 1917 and the remainder of  
 Barton by S. B. Edwards Surveyor Mar 1911. The  
 two lots known as the Jas. Lee and the M. H. Newman  
 lands were surveyed June 1896 by J. D. Norman,  
 Surveyor. I believe the Edwards and Norman  
 surveys to be correct. I have recalculated the Barton  
 land. Surveyed May 22nd 1917  
 M. E. Johnson  
 Surveyor

Registered, certified & Examined Jan 10<sup>th</sup> 1918