

EX PARTE  
SOUTHERN RAILWAY CO.

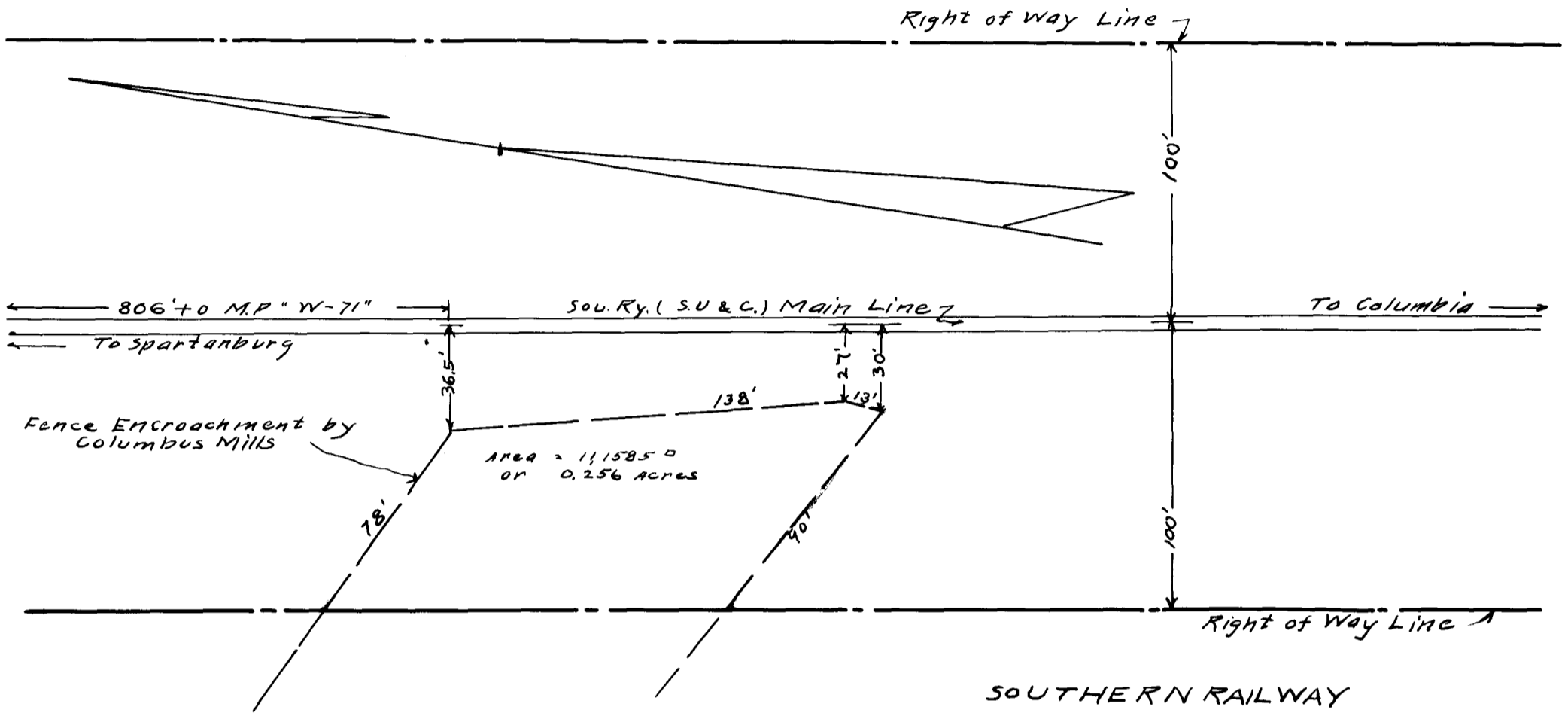

SOUTHERN RAILWAY  
 SPARTANBURG DIVISION  
 E. SPARTANBURG, S. C.  
 Sketch Showing Encroachment on Right of Way  
 by Fence of Columbus Mills  
 Oct. 10th 1916 J.G.T. Scale 1" = 50'  
 Correct: *J.A. Stillian*  
 Resident Engineer

Office of  
 Resident Engineer  
 Eastern District  
 Charlotte, N.C.

Note: See Deed Book 5-P page 771

Registered, Certified & Examined April 14-1917