

EX PARTE
GRACIE W. HEMBREE

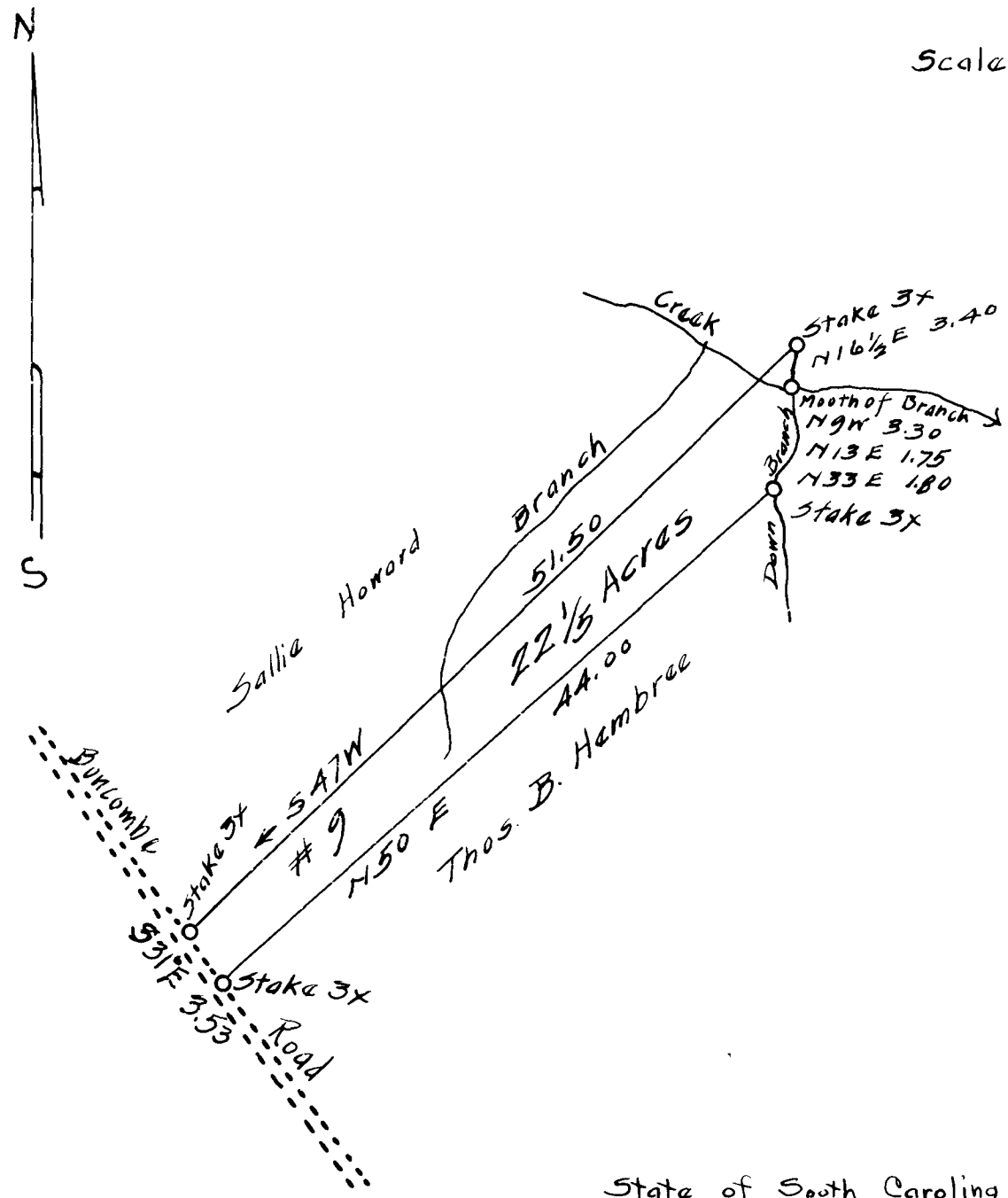

State of South Carolina
County of Spartanburg

W.M. Hembree
to
Gracie Woodruff Hembree
See W.M. Hembree's will 11/5/1917

Surveyed 12/11/1923
S. G. Anderson
Registered Surveyor.

Registered, Certified & Examined Jan. 14 - 1925