

EX PARTE
HILLCREST

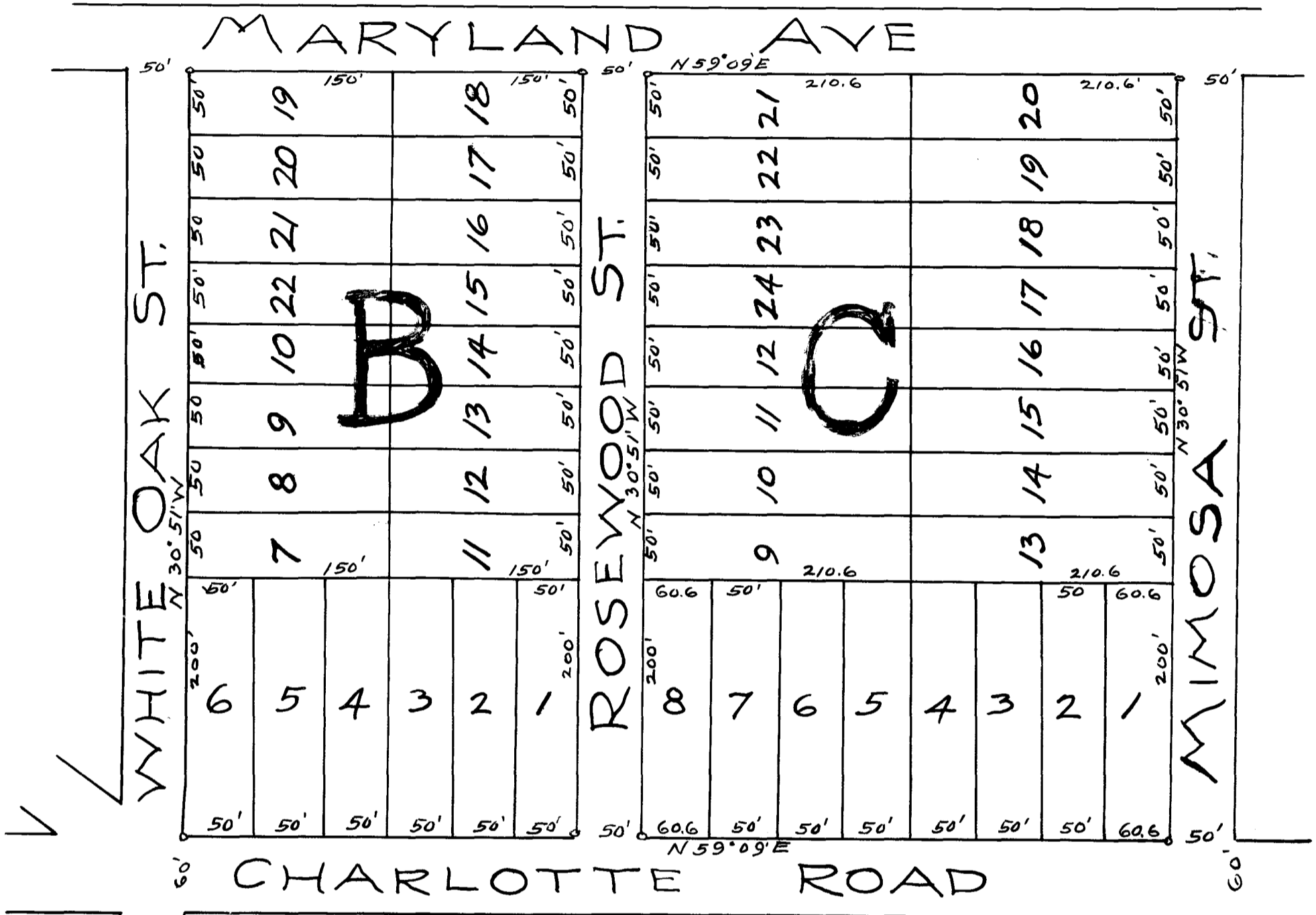

REVISION OF BLOCKS B & C,
 "HILLCREST"
 SPARTANBURG Co., S.C.
 SCALE 1"=100' MAY 3, 1926
 ORIGINAL PLAT RECORDED JUNE 4,
 1925, IN PLAT BOOK 9, PAGES 27-28
 W.W. WILLIS, ENGINEERS
 SPARTANBURG, S.C.

Registered, Certified & Examined May 4-1926 at 9:42 A.M.