

Page 8.

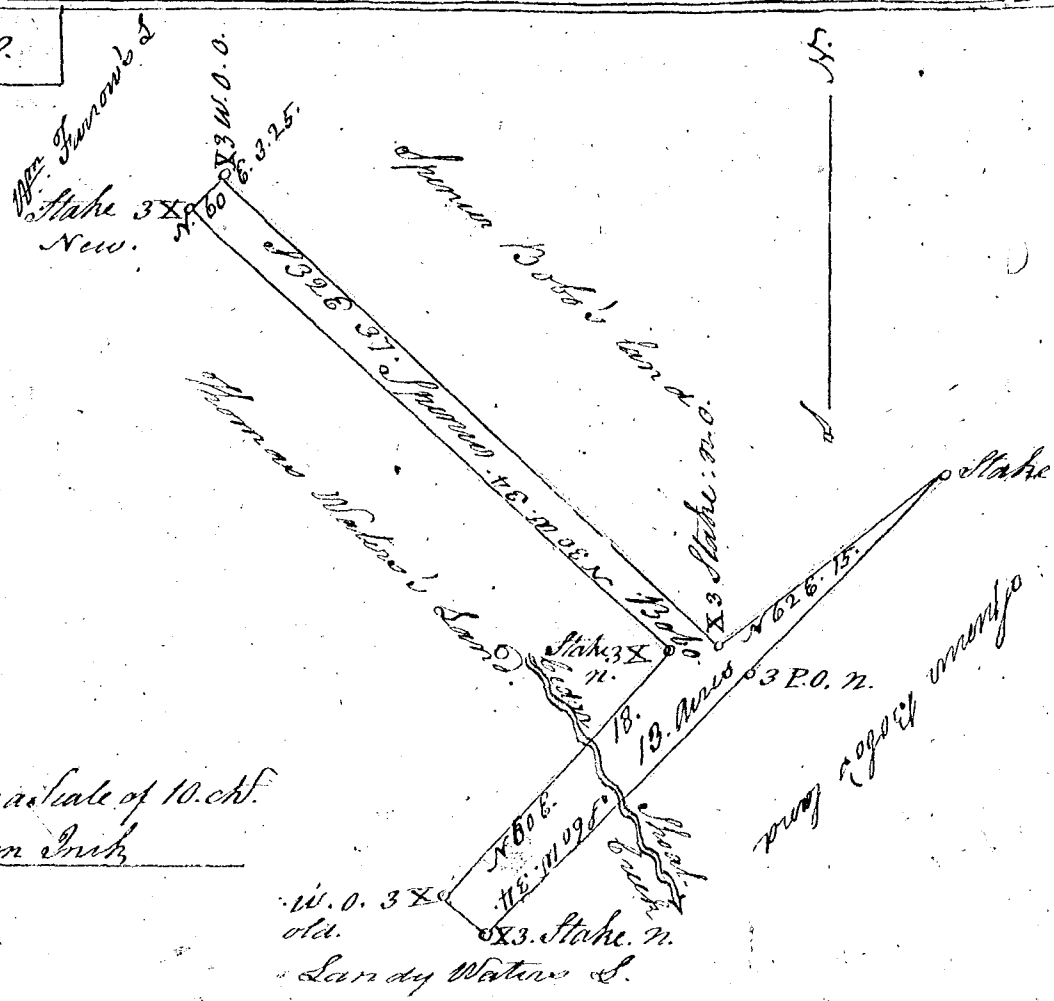

By a scale of 10. chf.
to an Inch

State of S. Carolina

By a warrant from James Smith Comr. of Locations for the district of Spartanburg dated the 14th day of April 1802. I have laid out unto Spencer Bobo a tract of three hundred acres of land situate lying in Spartanburg district on Cedar Shoal Creek waters of Enoree river adjoining with lands S. E. & N. E. & S. W. with Spencer Bobo's land & N. W. & N. E. with Sandy Waters, Thomas Waters & William Furnow's land & hath such shape and marks as the above plat Represents Survey'd the 17th day of April 1802.

Recorded the 3^d day of May 1802.

By J. H. Cofford D.S.