

64.

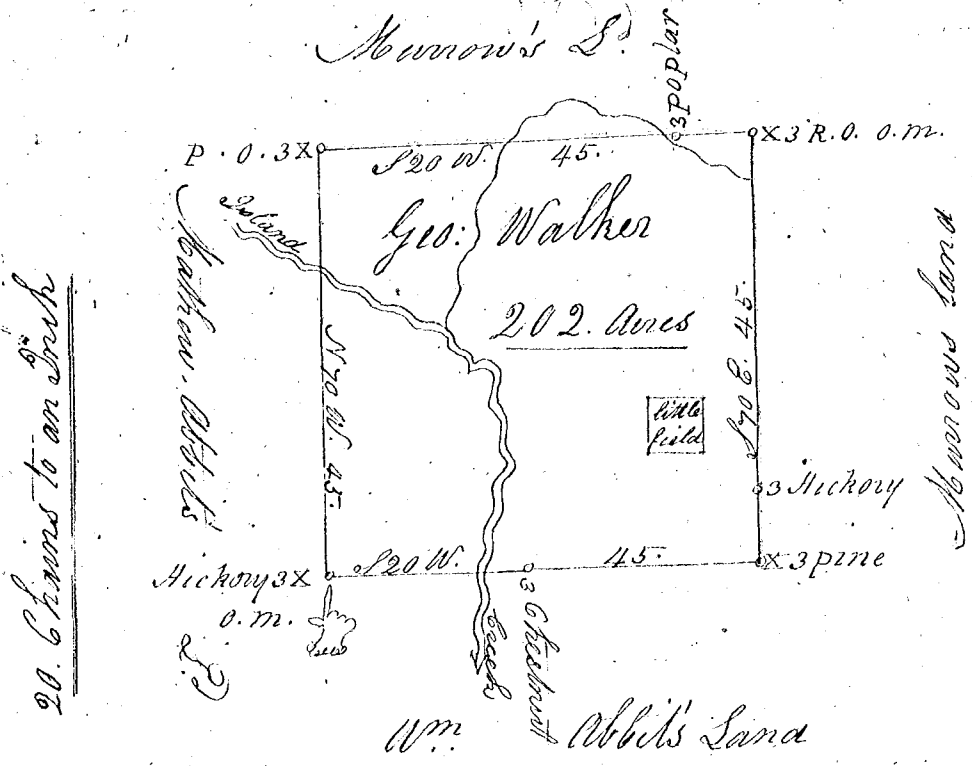

S of Carolina

In answer to a warrant from James Smith Commissioner of  
 locations for the district of Spartanburgh bearing date  
 the 27<sup>th</sup> day of May 1803. I have measured and laid  
 out unto George Walker a tract of land containing two  
 hundred and two acres Situate in said district lying  
 on both sides of Island creek waters of Pachall river, bounded  
 South and East by Murray's Land N<sup>o</sup>. by Matthew Abbots  
 land & West by William Abbots land, and such shape  
 form & marks as the above plat represents - Survey'd  
 the 28<sup>th</sup> day of May 1803.

By

Revised the 23<sup>rd</sup> day of July 1803.

Richard Thomson D.S.