

82.

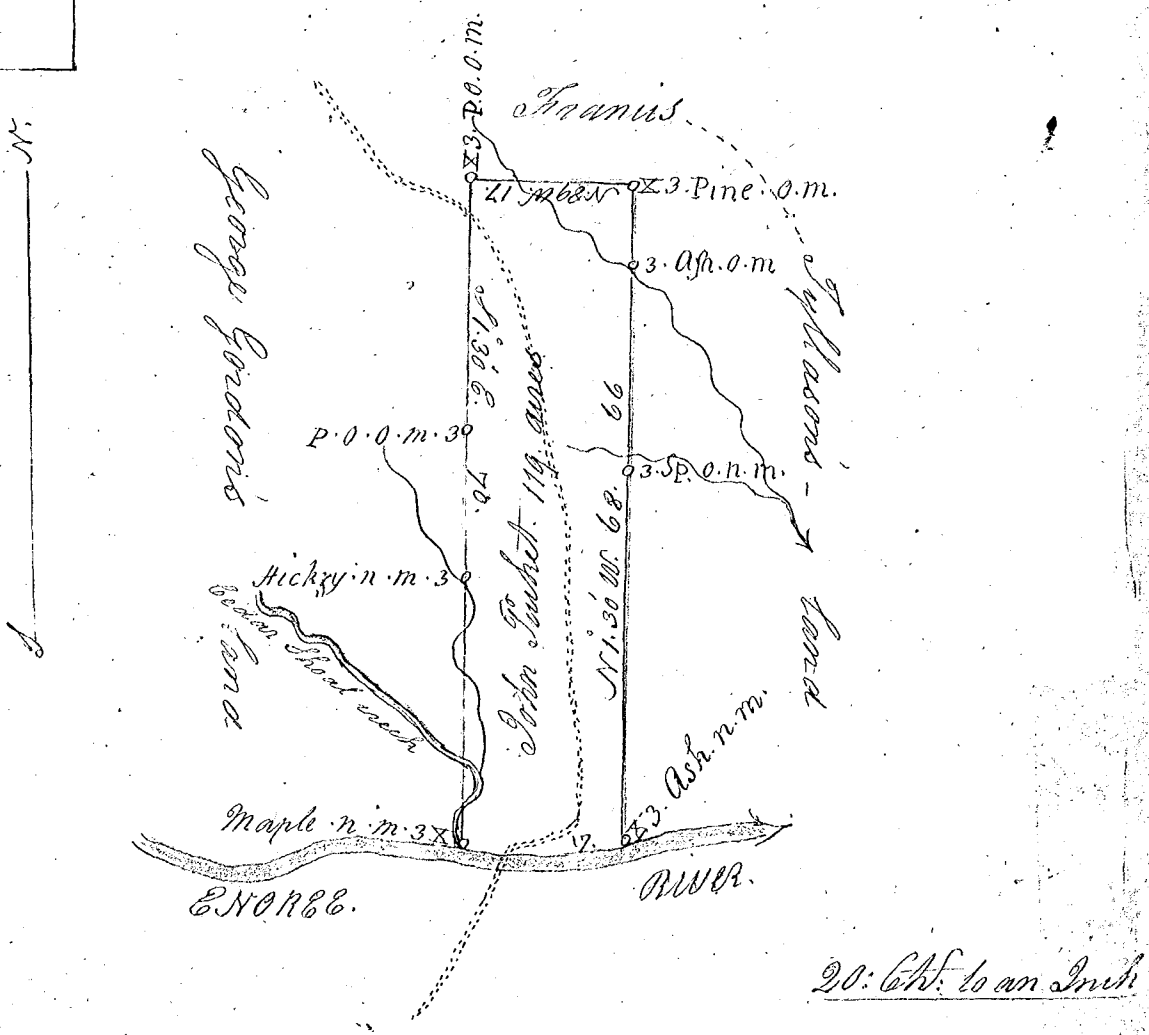

S. Carolina Spar-
tanburgh district }

Pursuant to a warrant from James Smith Esq. Com. of
of locations for the said district bearing date the 29th day
of October 1803. I have Survey'd for John Pickett a tract
of land containing one hundred & fifteen acres lying in
said district adjoining the Union line on the North side of
Enoree river below the mouth of Cedar shoat creek and is
bounded East & North by Francis Tyllerson's land & West
by the river & West by George Gordon's land and hath with
shape form & marches as the above plat represents
Survey'd the 31st day of October 1803.

Recorded the 5th day
of November 1803. }

By
Wm. R. Smith D.S.
~~~~~

see p. 10.