

219

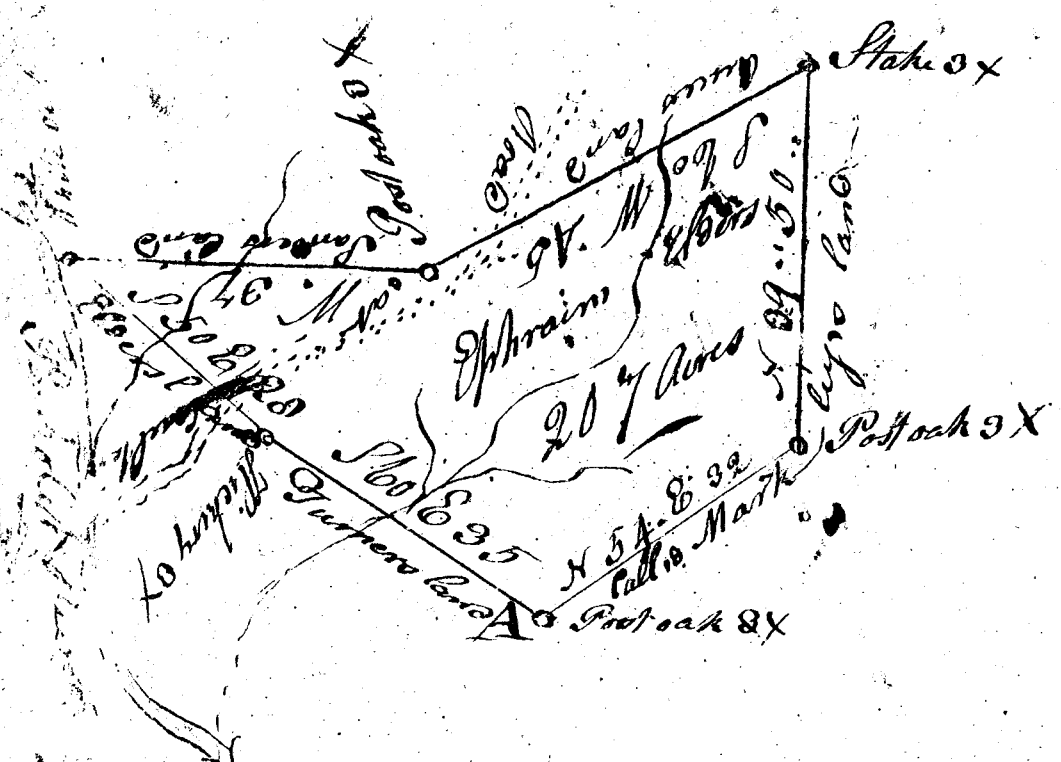

South Carolina } Pursuant to a Warrant from the
 the Edinburgh District } Smith Esq^r Commissioner of Land
 the S^d District Dated the 14th Oct^r 1806 }
 do measure and laid out unto Ephraim Eber
 a tract of land containing 20 7/8 acres situate in the
 District of South Carolina on the East side of Pacolite River bounded
 by a line running N. E. called Markley's line
 by S. Markley's land S. W. by Sanders land
 S. E. by the S^d Eber land
 S. E. by Turners land and hath set
 the same forms & marks as the above plat
 represents & surveyed on the 12th Nov^r 1806

Henry Turner

and the 12th day of
 November 1806