

242

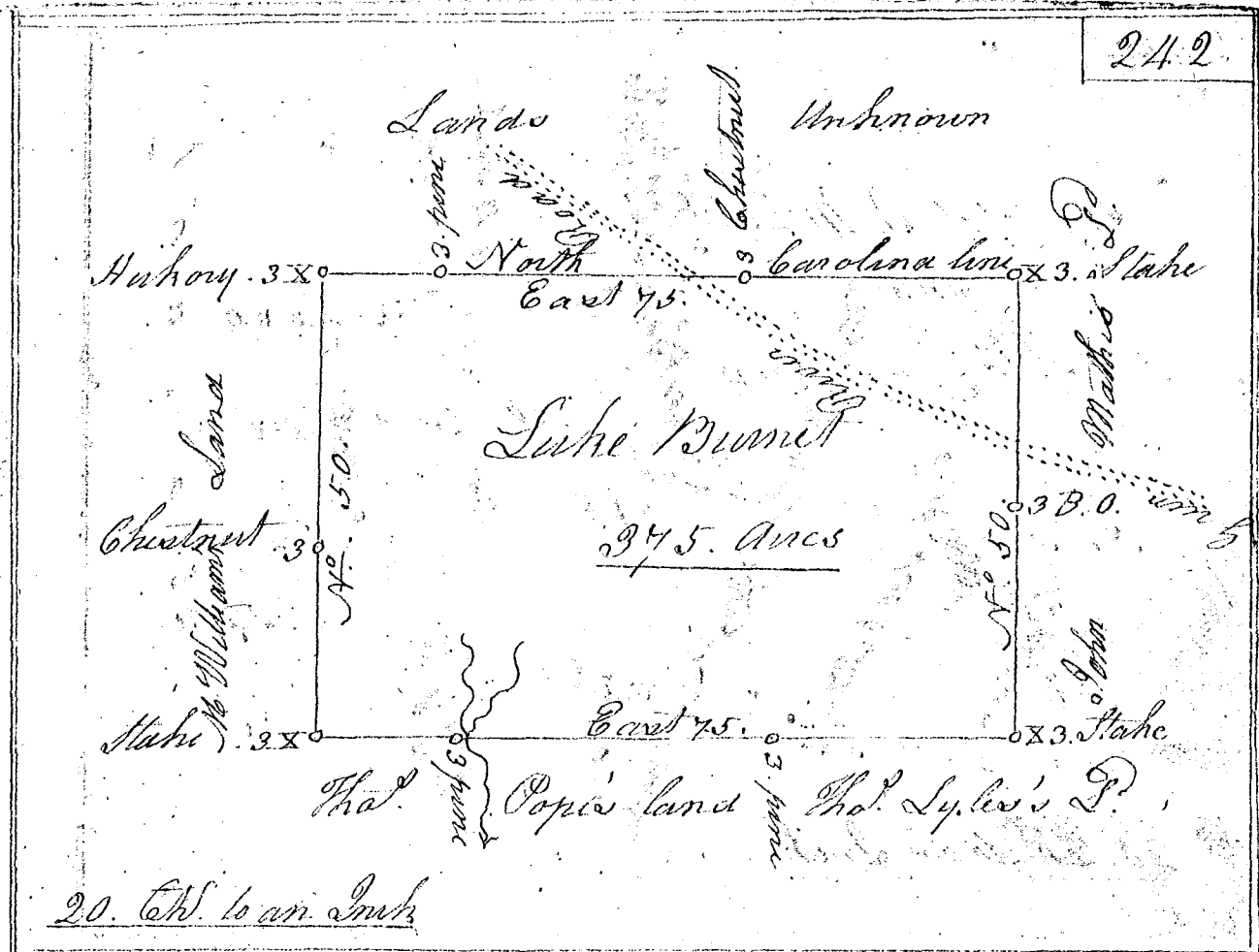

S. Carolina Spartanburgh district } Pursuant to a warrant from James  
 Smith Esquire Commissioner of locations  
 for the district of Spartanburgh bearing date the second  
 day of October 1807. I have admeasured & laid out  
 unto Sube Burnet a tract of land containing  
 three hundred & seventy five acres lying in said  
 district on waters of Bush Creek adjoining the  
 State line on the N<sup>o</sup>. East by Mather's land South  
 by Popo's & Sules's land & West by M. Williams's land  
 & hath such marks & bounds as the above plat re-  
 presents Survey'd the 6<sup>th</sup> day of October 1807—  
 By  
 Henry Turner D.<sup>s</sup>

Recorded the 8<sup>th</sup> day  
 of October 1807 }