

54

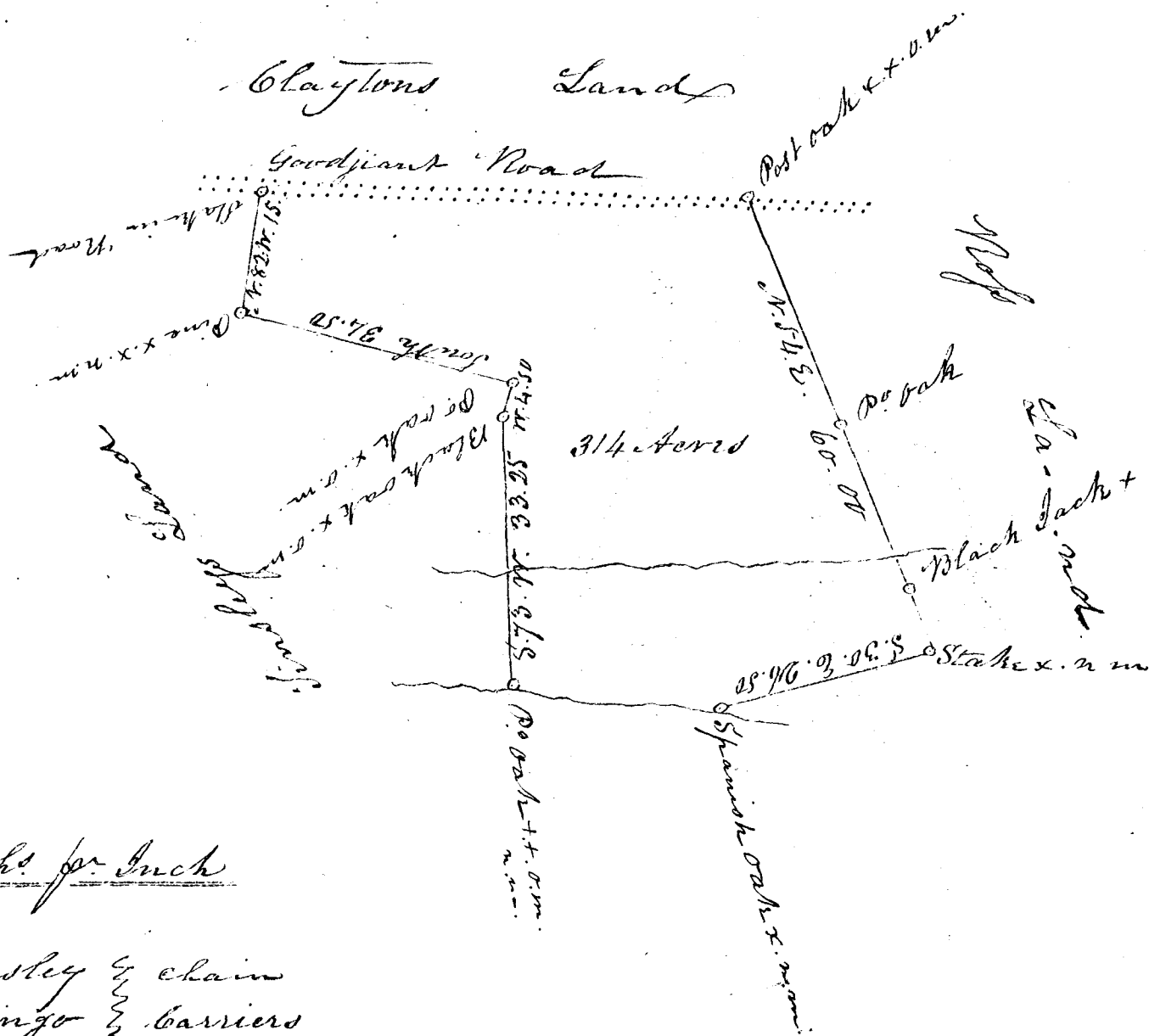

South Carolina  
Spartanburgh Dis. 5

Pursuant to a warrant granted 17<sup>th</sup> Jan'y 1840. from Judge Galt-  
Commissioner of Locations for Spartanburgh District, I have laid  
out for Sirpatow Sinsley a Tract of Land lying in Spartanburgh  
District & on the waters of North Syger & bounded N. E. by Rops  
Land & S. W. & South by Sinsley's Land & hath such Shapes  
Bettings & Boundaries as the above plat Represents. Survey: 28<sup>th</sup>  
January 1840.

John Snoddy D.S.

Recorded the 17<sup>th</sup> Feb'y 1840.

Fees \$2.12 1/2  
paid 62 1/2  
\$1.50 p<sup>d</sup>.