

J E Wootton
Platt 81 Acre

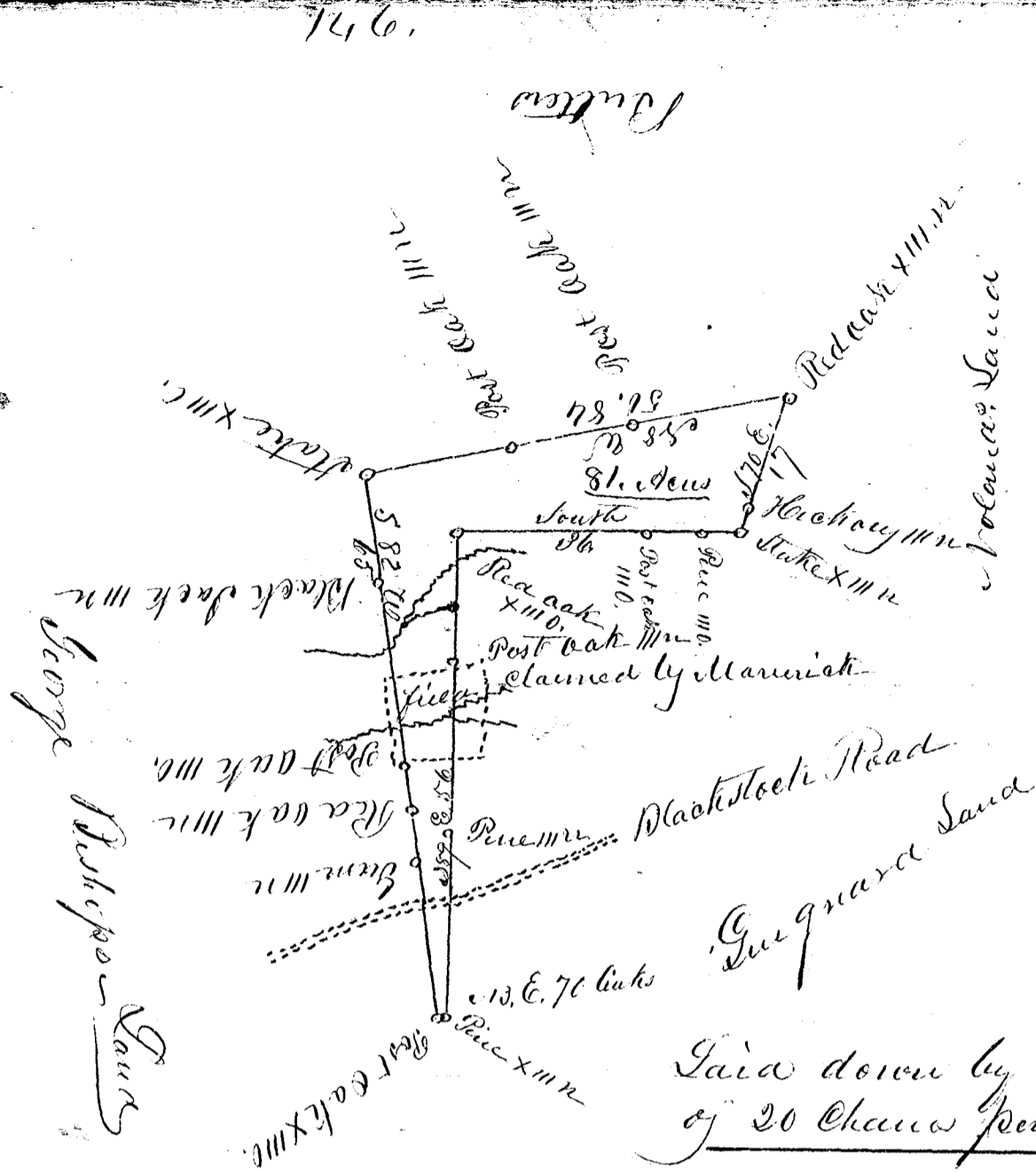

South Carolina

Pursuant to a warrant from J B Tolleson Commi-
-sioner of location in the District of Spartanburgh dated the 19th
day of February 1849. I have admeasured and laid out unto
J E Wootton a tract of land containing Eighty one acres. Situated
in the said District on the Blackstock road and Branches
The Waters of Lawson's fork of Pacolet, river bounded by
Cunning M. with George Bishop's land N.W. by Guignard's
land and South Creek form and marked as the above
plat represents, surveyed the 19 day of February 1849.

W. S. Dupree
J E Wootton 3 1/2

John Epton
Jr.

Recorded the 6th March 1849