

Wm Waldrop

20 Ch per Inch

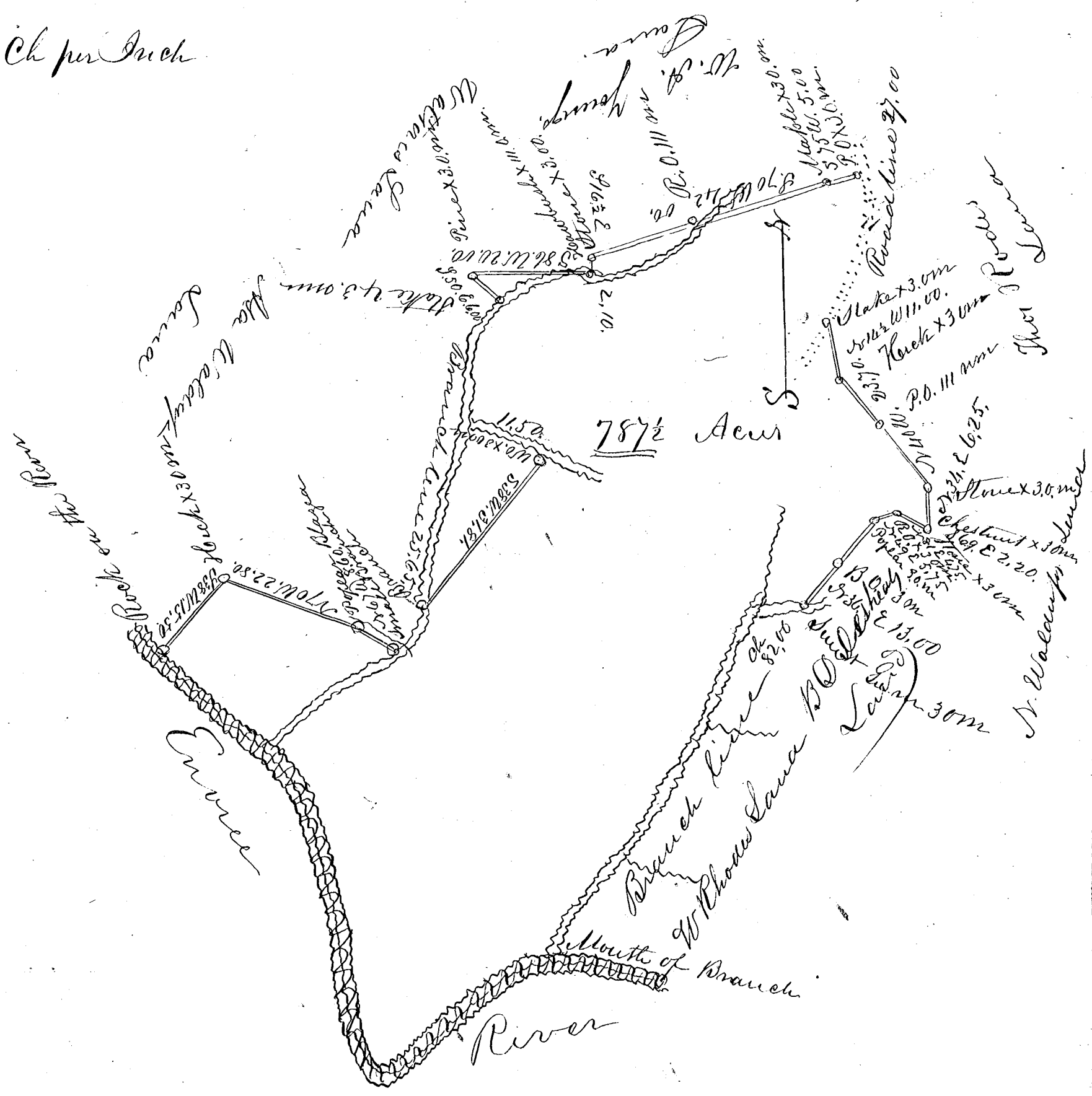

South Carolina,  
 Spartanburgh District, Pursuant to a Warrant from J.B. Tolleson  
 Com of Location for Spartanburgh District  
 I have admeasured and laid out, unto William Waldrop  
 a tract of Land lying in said District on the North side  
 of Quince River containing 787 1/2 acres bounded by lines  
 running N.E. by Wm Rhoads & B Desheals N.W. by Thomas Rhoads  
 & S.W. by Watson & Asa Waldrop Warrant dated 8 Oct 1850,  
 and hath such shape & form as the above plat represents  
 Surveyed this 9 Oct 1850

John Gibbs Jr

Recorded this 4 Nov 1850