

186

Col W Harris

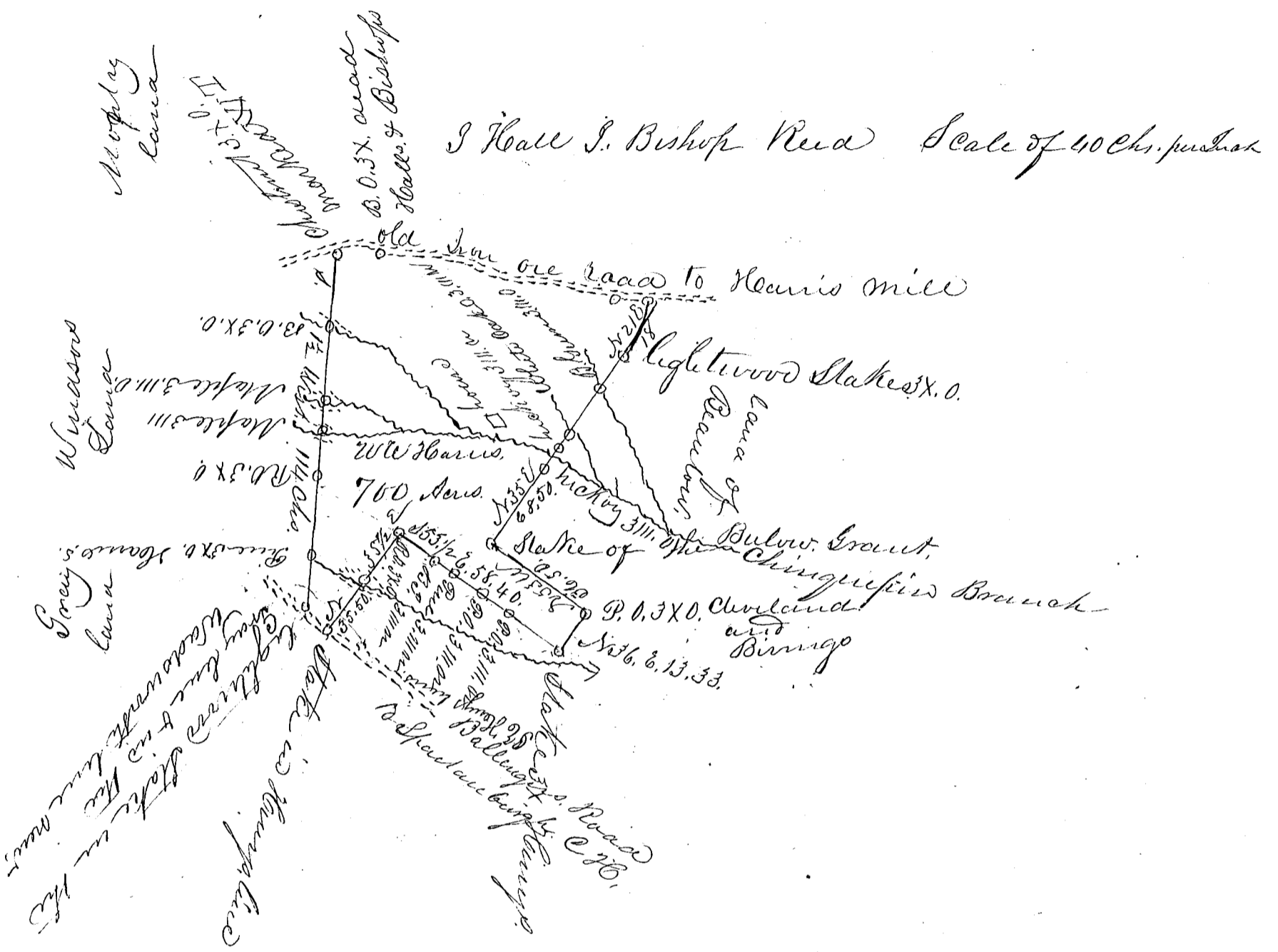

### South Carolina

Pursuant to a warrant from J. B. Tolson  
 Commissioner of Location in the district of Spauldburgh  
 dated the 26<sup>th</sup> of April 1831, I, have measured & laid  
 out to William W. Harris a tract of land containing  
 of seven hundred acres, situated in said District on Chingquippin  
 Creek a branch of Sawyers fork of Pacolet River  
 bounded on the N. by land of J. Hall S. Bishop and  
 Reed on the East, by lands granted to Beaulieu on  
 the South by lands of Henry & Cleveland on the West  
 by land granted to Gray, Winason & others & hath  
 such form and bounds, as is above represented  
 Surveyed the 28<sup>th</sup> day of April 1831. The object of the  
 Plat is to regrant almost entirely a small portion  
 supposed to be vacant.

Albert Harris  
 William H. Ray & Co.

W. W. Harris  
 Deputy Surveyor

Revised the 21 April 1831