

Wm Lipscomb Esqr
Platt, 66 Aers.

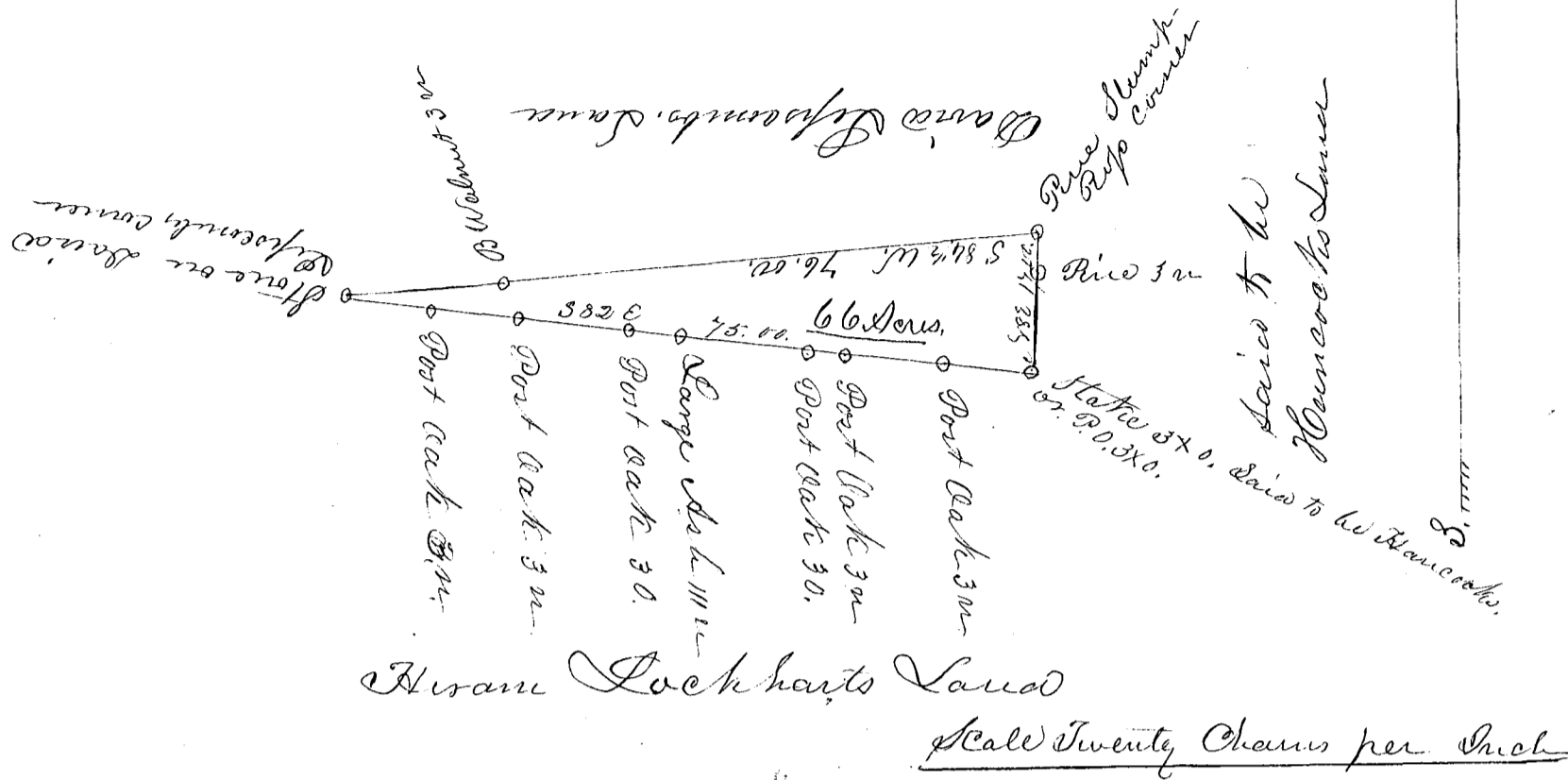

South Carolina

Pursuant to a warrant, from J B Tolson Esqr, Commissioner of location in the District of Spentanturgh dated the 8th day of November 1851. I have admeasured and laid out, unto William Lipscomb Esqr, a Tract, of land containing sixty six acres, situated in the said district on the South. Side of Skellons Creek of Thickety wats of Broad River bounded by a line running S. W. by land owned by David Lipscomb,

S. E. by Hiram Lockhart, N. E. by land said to be owned by Hancock and hath such form and marks, as the above plat represents, Surveyed the 8th day of November 1851,

John Epling
D S,

Recorded the 15 day of December 1851,