

208

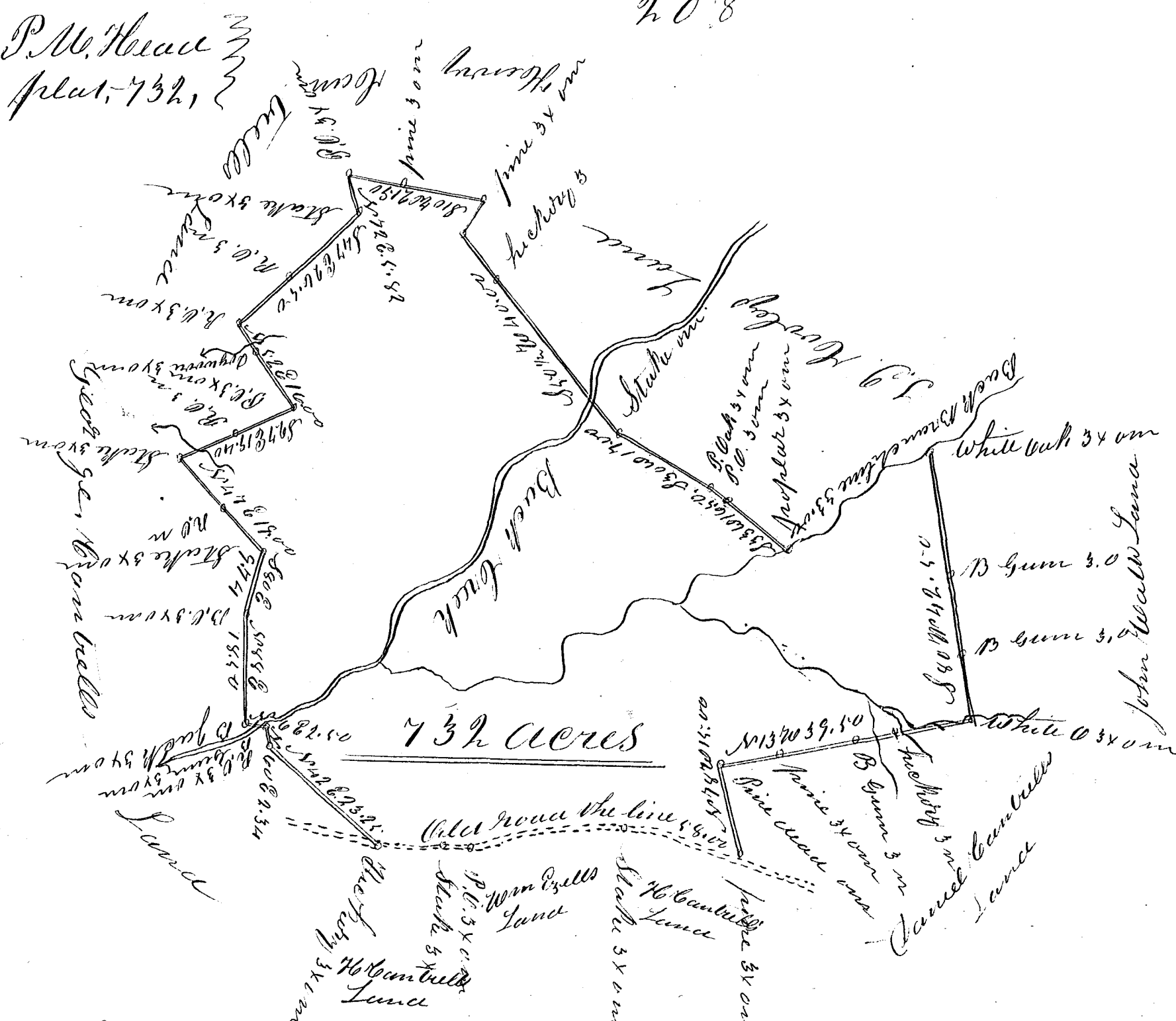

Laid down by a Scale of Twenty Chains to an Inch

South Carolina

Pursuant to a warrant from J. B. Tolson Commissioner of Locations in the District of Spartanburg dated the 20<sup>th</sup> day of March 1852. I have measured and laid out unto P. M. Head a tract of land containing seven hundred and thirty two acres, situated in said District on Buck Creek waters of Sacolet River, bounded by lines running S. E. and N. E. by lands of Hervey Cantrell, George Cantrell, H. Cantrell and William Ezell, and N. W. and S. W. by Daniel Cantrell, John Walls, and J. J. Cowley having been formerly granted and this survey is made to obtain a new Grant, having such form and marks as the above plat represents, Surveyed the 23<sup>rd</sup> day of March 1852.

John Epton  
Deputy Surveyor

Recorded the 2<sup>nd</sup> day of April 1852,