

266

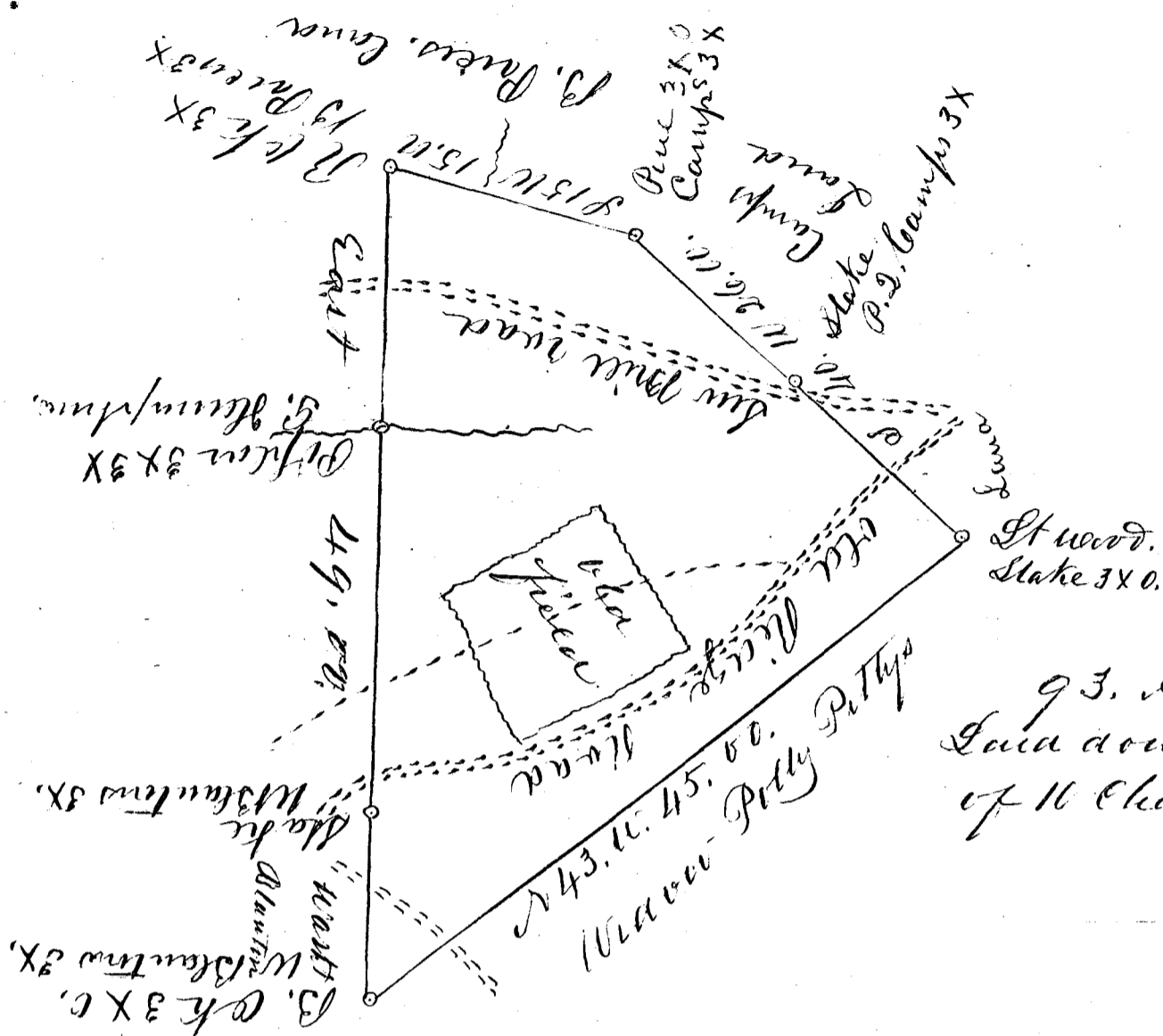

South Carolina

Pursuant to a warrant from J. P. Tolleson Esq. Commissioner of Location in the district of Spartanburgh dated the second day of August 1853. I have admeasured & laid out unto Benjamin Price a tract of land containing nearly three acres. Situated in the said district on a branch of Beaverdam fork of Shickett Creek bounded by a line running N. W. by lands belonging to Widow Petty S. H. by lands of said Petty & P. Quinn Camps & B. Price and East by lands of Mr Daniel S. H. Humphreys & W. Blanton and hath such form and marks as the above plat represents Surveyed the fourth day of August 1853. Witness my hand the 28 Sept 1855

P. Quinn Camps
D. S.